



SPRINGER FORKS

- OEM-style replica that exceeds OEM quality
- Measures 95 cm H
- Weighs 21 kg
- Upper triple clamp must be ordered separately
- Axle and brake kit sold separately
- Includes documentation in five languages

| PART # | DESCRIPTION | RAKE ANGLE |
|---|----------------------------|------------|
| FOR 19 MM (3/4") WHEEL AXLE | | |
| 0401-0091 | Black body/chrome springs | 3° |
| 0401-0092 | Chrome body/chrome springs | 3° |
| 0401-0093 | Black body/black springs | 3° |
| FOR 08-11 FLSTSB | | |
| 0401-0094 ¹ | Black body/chrome springs | 8° |
| FOR 25,4 MM (1") WHEEL AXLE (ABS COMPATIBLE) | | |
| 0401-0095 | Black body/chrome springs | 3° |
| 0401-0096 | Chrome body/chrome springs | 3° |

¹ Includes upper triple clamp.



SPRINGER TRIPLE CLAMP FOR SPRINGER HANDLEBARS

- Allows you to mount handlebars made for Springer forks
- 3° rake angle triple clamp made from high-strength steel
- Measures 4 3/4" inches between risers
- Includes studs and rigid fork leg
- For the complete line of Classic Bike springer triple clamps, see page 1566 of the 22 Parts Europe FatBook

| PART # | DESCRIPTION |
|-----------|---|
| 0408-0399 | Springer triple clamp for Springer models |



AXLE KITS AND CALIPER BRACKETS FOR SPRINGER FORKS

- Replacement 25,4 mm (1") or 19 mm (3/4") axle
- Steel mounting brackets/brake links sold separately
- Brake links have 10 mm holes and 125 mm distance between holes
- Brake links are compatible with 11,50" brake rotors
- Caliper brackets accept Twin Cam and M-Eight calipers

| PART # | DESCRIPTION |
|-----------|-----------------------|
| 0450-0585 | 19 mm (3/4") axle kit |
| 0450-0586 | 25,4 mm (1") axle kit |



| PART # | DESCRIPTION |
|-----------|---|
| 0450-0583 | Mounting bracket and brake link, right side |
| 0450-0584 | Mounting bracket and brake link, left side |



V-5 SLIP-ON MUFFLER

- 5" disc-based stainless tunable muffler with spark arrestor
- Features two center pull retainer clamps that allow for slippage rather than breaking in the event of a tip over
- Almost six pounds lighter than stock
- Stainless S-bend connector pipe increases boot clearance
- Includes 22 pre-installed discs for a deep, low tone
- Also includes all necessary hardware for simple installation

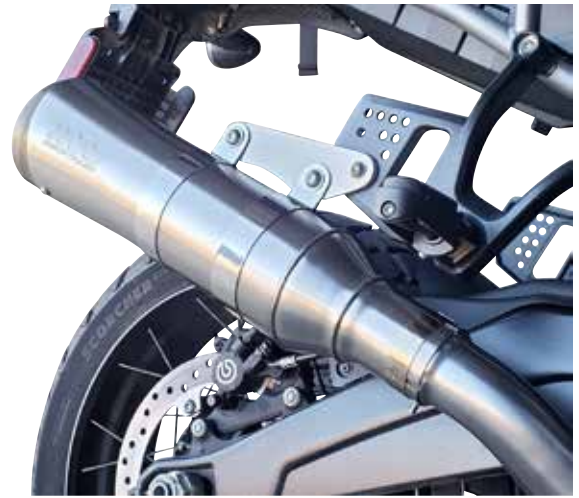

| PART # | DESCRIPTION |
|------------------|------------------|
| 1801-1501 | For 21-22 RA1250 |



1801-1493



4,5" MK45 CUTLASS PERFORMANCE MUFFLERS

- MK45 performance mufflers feature a bold 4,5" OD diameter with a new gloss black Cutlass end cap design
- Stainless steel baffles with RaceTEX packing
- Produce a deep bass rumble throughout the rev range
- Removable dB reducers
- Sold in pairs

NOTE: Not for H-D Trike applications.



1801-1496

| PART # | DESCRIPTION |
|---|--|
| FOR 17-21 FLHT/FLHTK/FLHTRU/FLHX MODELS | |
| 1801-1494 | Chrome w/ gloss black Cutlass end caps |
| 1801-1493 | Guardian black w/ gloss black Cutlass end caps |

| PART # | DESCRIPTION |
|--------------------------------------|--|
| FOR 99-16 FLHT/FLTR/FLHR/FLHX MODELS | |
| 1801-1496 | Chrome w/ gloss black Cutlass end caps |
| 1801-1495 | Guardian black w/ gloss black Cutlass end caps |



1010-2881



1010-2883



TUNED INDUCTION AIR CLEANERS

- Use two laser-cut and highly engineered tubes merged into a single collector, fed by a pair of high-flow air filters placed directly in the airstream
 - Bolt-on performance; more than twice the filter area compared to the stock intake system
 - Boosts horsepower and torque across the rpm range using air column inertia and carefully timed gas dynamic pressure waves
 - Smooth intake tract using carefully selected and tuned lengths to aid performance
 - High-flow, washable and reusable cotton media air filter elements
- NOTE:** Will not fit Touring models with fairing lower glove boxes or Twin-Cooled models.

| PART # | FINISH | DESCRIPTION |
|-----------|-------------|---|
| 1010-2881 | Gloss black | For 17-22 M-Eight |
| 1010-2883 | Chrome | For 08-16 FLHT/FLHR/FLHX/FLTR/H-D Trike, 16-17 FXDLS and 16-17 Softails |



HIGH FLOW AIR FILTER

- 4-ply washable filter media for better filtration
- Provides 20% increase in airflow

| PART # | DESCRIPTION |
|-----------|-----------------------------|
| 1011-4580 | For 20-21 Indian Challenger |



POWER VISION 4

- Flash tunes to your ECU – no setup required, just create an account, select your tune, flash and enjoy the ultimate ride
- Access to a vast database of pre-loaded tunes for different configurations
- Easily download and manage pre-loaded and custom tunes
- Record real-time engine data and display in WinPEP 8 Data Center
- Optimized for remote tuning so you can easily ride, record and share data logs and tunes
- Read, review, clear and share diagnostic trouble codes (DTCs) with built-in descriptions
- Supports licensing additional vehicles
- Return to stock at any time, your original factory tune is safely backed up on the cloud and on your phone
- See Dynojet website: <http://www.dynojet.com/powervision-tune-license-programs.aspx> for information about purchasing additional Power Vision licenses

MANUFACTURER'S NOTE: All Power Vision returns and/or adjustments must be made directly through Dynojet Research. The Power Vision may be used on any bike to read and clean trouble codes.



PART

DESCRIPTION

1020-3524

For 14-20 FLHT/FLHX/FLHR/FLTR/FLTRX/FLTRU, 11-20 Softail, 12-17 Dyna, 14-21 XL and 15-20 Street models

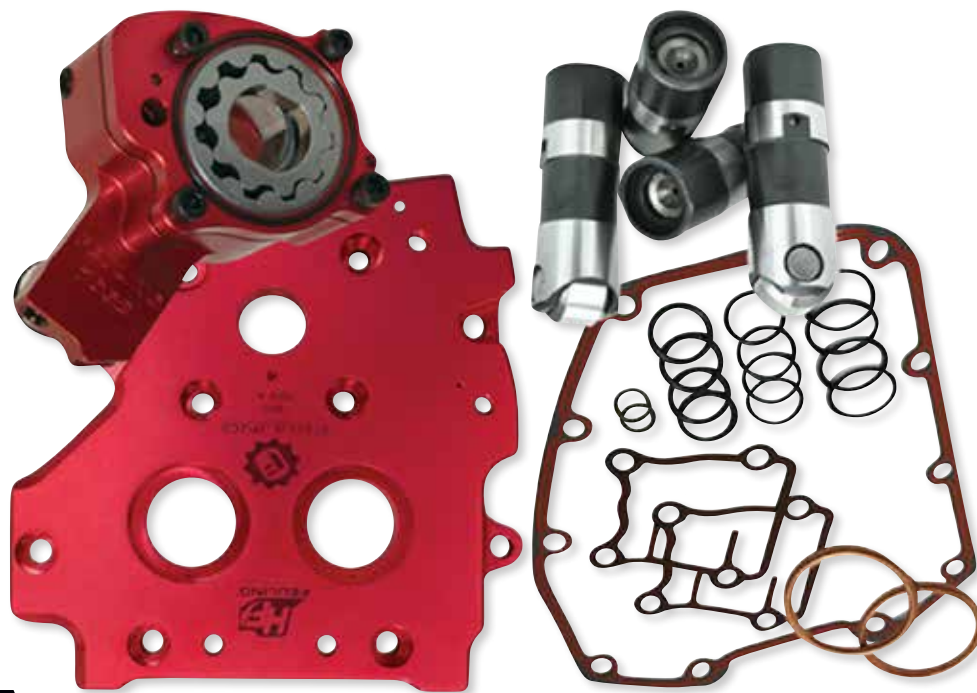

RACE SERIES® OIL SYSTEM PACK FOR TWIN CAM

- Quieter and smoother engine operation
- Increase oil pressure, scavenge volume and engine oil flow
- 15-35 °F cooler engine temperatures
- 15-30 °F cooler oil temperatures
- 15-30 more psi of oil pressure
- Eliminate wet sumping, blowby and oily air cleaners
- Test results show 3 horsepower gain and 4 ft./lb. of torque gain to the rear wheel
- Includes Race Series oil pump, Race Series short-travel hydraulic roller lifters, high flow camplate and cam installation kit
- Billet 7075 aluminum oil pump is 50% harder and stronger than the factory pump; holds tighter tolerances under temperature
- Race Series short-travel hydraulic lifters have 0.115" of total travel and will increase rpm by decreasing valve float and valve-train harmonics while maintaining a quiet engine

- The travel reduction reduces the amount of oil that is required to fill the inside of the lifter which reduces oil aeration inside the lifter on steep, fast action high lift camshaft lobes

NOTE: Optional Feuling x ARP oil pump/ camplate bolt kit available PART #2401-0993 (see 2022 Parts Europe FatBook).

NOTE: Gear Drive cam systems require block-off plate kit PART #0932-0036 (see 2022 Parts Europe FatBook).

NOTE: Use with short-travel pushrods PART #0928-0116 on stock base circle camshafts (Feuling 525, 543 and 574 grinds) and PART #0928-0117 on small base circle camshafts (Feuling 594 and 630 grinds). PART #s 0928-0116 and 0928-0117 sold separately; see 2022 Parts Europe FatBook.

PART

DESCRIPTION

0932-0291

For 07-17 Twin Cam and 06 Dyna with Gear or Chain Drive



PREMIUM PERFORMANCE BATTERIES

- AGM (Absorbed Glass Mat) separators with superior grid and component designs allow Drag Specialties to offer one of the most powerful batteries in the industry
- Improved charge recovery capability from a deeply discharged condition
- Longer shelf life
- Improved life cycle performance
- Extreme vibration resistance
- Factory-Activated, spill-proof design
- Upgrade for customized motorcycles requiring the best performance

NOTE: Factory-Activated batteries should be charged once a month when not in service.



2113-0455



2113-0453

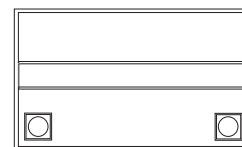

| PART # | DESCRIPTION |
|-----------|--|
| 2113-0455 | For 99-21 FLT/ FLHT/ FLHX/ FLTR/FLTRX/FLTRU/ FLTRK/ FLHR and H-D FL Trikes |
| 2113-0454 | For 00-21 Softail, 99-17 FXD/ FXDWG/ FLD |
| 2113-0452 | For 04-21 XL (except 21 Sportster S/RH1250S), 15-20 XG 500/ 750/ 750A |
| 2113-0454 | For 97-03 XL |
| 2113-0453 | For 86-96 XL |
| 2113-0454 | For 07-17 V-Rod VRSCA/D/DX/CX |

| PREMIUM PERFORMANCE PART # | YUASA REF. # | HARLEY-DAVIDSON OEM # | COLD CRANKING AMPS | LENGTH | WIDTH | HEIGHT | TERMINAL CONFIGURATION |
|----------------------------|--------------|-----------------------|--------------------|--|---|--|------------------------|
| 2113-0455 | GYZ32HL | 66010-97A/C/D | 500 | 17 cm (6 ⁹ / ₁₆ " | 12,5 cm (5") | 17,5 cm (6 ⁷ / ₈ " | - + |
| 2113-0453 | GYZ20H | 65991-82B | 320 | 17,5 cm (6 ⁷ / ₈ " | 87 mm (3 ⁷ / ₁₆ " | 15,5 cm (6 ¹ / ₈ " | + - |
| 2113-0454 | GYZ20HL | 65989-97A/D | 320 | 17,5 cm (6 ⁷ / ₈ " | 87 mm (3 ⁷ / ₁₆ " | 15,5 cm (6 ¹ / ₈ " | - + |
| 2113-0452 | GYZ16HL | 65958-04 | 240 | 15 cm (6") | 87 mm (3 ⁷ / ₁₆ " | 14,5 cm (5 ³ / ₄ " | - + |

DRAG SPECIALTIES HIGH PERFORMANCE BATTERIES

- Specifically designed for high-performance engines that need extra cranking power
- Superior engineering features include an AGM (Absorbed glass-mat) radial grid design for maximum cranking amps
- High vibration resistance
- Spill-proof, pre-filled, pre-charged, maintenance-free sealed design
- Batteries include brass spacers, stainless steel nuts, bolts and star washers

NOTE: Factory-Activated batteries should be charged once a month when not in service.



2113-0451



2113-0448

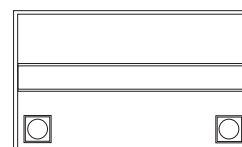

| PART # | DESCRIPTION |
|--------------------------|---|
| BIG TWIN/XL/V-ROD | |
| 2113-0451 | For 99-21 FLT/ FLHT/ FLHX/ FLTR/ FLTRX/ FLTRU/ FLTRK/ FLHR and H-D FL Trikes |
| 2113-0449 | For 00-21 Softail, 99-17 FXD/ FXDWG |
| 2113-0447 | For 04-21 XL (except 21 Sportster S/ RH1250S), 15-20 XG 500/750 |
| 2113-0449 | For 97-03 XL |
| 2113-0448 | For 86-96 XL |
| 2113-0449 | For 07-17 V-Rod VRSCA/D/DX/CX |
| 2113-0446 | For 02-06 V-Rod, 07 VRSCR |
| BUELL | |
| 2113-0446 | For 96-99 S1, 00-07 Blast (requires battery adapter from Buell) |
| 2113-0448 | For 94-96 S2, S2T Thunderbolt, 88-90 RR1200, 89-93 RS1200, 91-93 RSS1200, 87 RR1000 |
| 2113-0449 | For 94-02 S3, S3T Thunderbolt, M2 Cyclone, X1 Lightning |

| FACTORY-ACTIVATED PART # | YUASA REF. # | HARLEY-DAVIDSON OEM # | COLD CRANKING AMPS | LENGTH | WIDTH | HEIGHT | TERMINAL CONFIGURATION |
|--------------------------|--------------|-----------------------|--------------------|--|---|--|------------------------|
| 2113-0446 | YTX14 | 65948-00 | 200 | 15 cm (6") | 87 mm (3 ⁷ / ₁₆ " | 14,5 cm (5 ³ / ₄ " | + - |
| 2113-0447 | YTX14L-BS | 65958-04 | 200 | 15 cm (6") | 87 mm (3 ⁷ / ₁₆ " | 14,5 cm (5 ³ / ₄ " | - + |
| 2113-0448 | YTX20H-BS | 65991-82B | 310 | 17,5 cm (6 ⁷ / ₈ " | 87 mm (3 ⁷ / ₁₆ " | 15,5 cm (6 ¹ / ₈ " | + - |
| 2113-0449 | YTX20HL-BS | 65989-97A/D | 310 | 17,5 cm (6 ⁷ / ₈ " | 87 mm (3 ⁷ / ₁₆ " | 15,5 cm (6 ¹ / ₈ " | - + |
| 2113-0450 | YTX24HL-BS | 66010-82B | 350 | 20,5 cm (8 ¹ / ₈ " | 87 mm (3 ⁷ / ₁₆ " | 16 cm (6 ³ / ₈ " | - + |
| 2113-0451 | YIX30L | 66010-97A/C/D | 385 | 17 cm (6 ⁹ / ₁₆ " | 12,5 cm (5") | 17,5 cm (6 ⁷ / ₈ " | - + |



FAT BAGGERS, INC.

Fat Baggers offers a simple, quick solution to upgrade the stock or FatBaggers EZ Clutch Extensions. The new upgrade kit converts your factory cable adjuster to a screw-type adjuster for easier use. It also works as a fast, durable repair for a broken adjuster.



EZ CLUTCH ADJUSTER UPGRADE KIT

- Converts the factory upper clutch cable adjuster to a screw-type adjuster
- Reinforces the clutch cable
- Works as a repair part for a broken HD factory cable adjuster
- Works with stock clutch cable and Fat Baggers EZ Clutch Extensions
- Dimensions: 1/2"-20 threaded split adjuster



PART

0660-0013

DESCRIPTION

For 21 FLHT/FLHTK/FLHX/FLHXSE/FLHTKSE/FLHTCUTG/FLHTCUTGSE/FLTRK/FLTRXS/FLTRX/FLTRXSE/FLHR/FLHRXS (clutch cable models) and 18-21 Softail



QUICK CONNECT BRAIDED UPPER CLUTCH CABLES

- Quick Connect braided upper clutch cables economically replace the OE upper cable section on 2018-2021 Softails and 2021 Touring models
- Easily and quickly connects to the existing lower cable section
- Significantly reduces installation time, plus there's no need to drain transmission fluid
- Unique design reuses OE cover and housing parts
- Quick Connect cables feature the industry's highest quality braid in two color choices to complement your bike: Sterling Chromite or KarbonFibr
- KarbonFibr braid is created from metallic distinct black tone colored wire, blended and interwoven to mimic the distinct look of carbon fiber
- Braid color and weave match on all Magnum control cables and brake lines
- Crystal-clear outer jacket will never discolor and provides exceptional protection against scuffing paint and chrome
- Chrome or black chrome-plated handlebar fittings
- Low-effort, high-efficiency cable design meets or exceeds OE specifications for fitment, construction and endurance
- Upper cables are made with anti-friction inner liners and are factory lubricated for smooth, consistent, long lasting operation

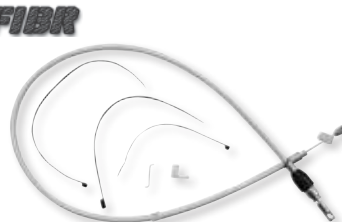

Sterling Chromite

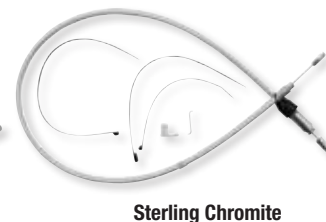

Sterling Chromite



Karbonfibr

STOCK LENGTH

| FITS MODEL | STERLING CHROMITE | TOTAL LENGTH (CM) | TRAVEL (MM) | OEM # |
|---|-------------------|-------------------|--------------------------------------|----------|
| For 21 FLHR/FLHRXS | 0652-2464 | 106,5 (42") | 59 (2 ⁵ / ₁₆ " | 37200440 |
| For 18-21 FLHC/FLHCS, 18-20 FLXR | 0652-2463 | 101,5 (40") | 59 (2 ⁵ / ₁₆ " | 37200218 |
| For 18-21 FLFB/FXBB/FXBBS/FXST, 18-21 FLFBS | 0652-2464 | 106,5 (42") | 59 (2 ⁵ / ₁₆ " | 37200216 |

ALTERNATE LENGTH

| STERLING CHROMITE | KARBONFIBR | TOTAL LENGTH (CM) | TRAVEL (MM) |
|-------------------|------------|-------------------|--------------------------------------|
| 0652-2463 | - | 101,5 (40") | 59 (2 ⁵ / ₁₆ " |
| 0652-2464 | - | 106,5 (42") | 59 (2 ⁵ / ₁₆ " |
| - | 0652-2504 | 112 (44") | 59 (2 ⁵ / ₁₆ " |



BIG SUCKER™ STAGE I AIR FILTER KIT FOR TWIN CAM

- One-piece aluminum backing plate features hidden breather technology
- Each hidden breather is O-ringed at the heads and exits at the mouth of the injector/ carb to provide efficient engine breathing, eliminating the need for any external hoses or hardware
- Radius air inlet provides maximum performance by providing unobstructed airflow
- Black powdercoat backing plate
- Standard red filters are pre-oiled, washable and feature four layers of surgical-grade cotton for optimum filtration and maximum airflow
- Accepts custom Ness outer cover
- All necessary hardware and instructions are included with each kit



| PART # | DESCRIPTION |
|------------------|--|
| 1010-2941 | For 01-17 Twin Cam Delphi EFI models and 99-06 Twin Cam CV carb models (except 08-17 FLHT/ FLHR/ FLHX/ FLTR/H-D FL Trike, 16-17 Softails, 16-17 FXDLS, 08-17 FXD/ FXDWG) |

INVERTED, METHOD, CLEAR TEAR AND SIDEKICK REPLACEMENT BREATHER BOLT COVER PLATES

- CNC-machined covers that hide the breather bolts (left and right sides sold separately)

1014-0312



1014-0321



| PART # | DESCRIPTION |
|---|---------------|
| FOR 17-22 FLHT/ FLHR/ FLHX/ FLTR/H-D TRIKE, 18-22 SOFTAIL MODELS | |
| 1014-0312 | Left, black |
| 1014-0314 | Right, black |
| 1014-0313 | Left, chrome |
| 1014-0315 | Right, chrome |
| FOR 08-16 FLHT/ FLHR/ FLHX/ FLTR/H-D TRIKE, 16-17 SOFTAIL, 14-15 FLSTNSE, 13-14 FXSBSE, 11-12 FLSTSE, 16-17 FXDLS MODELS | |
| 1014-0316 | Left, black |
| 1014-0318 | Right, black |
| 1014-0317 | Left, chrome |
| 1014-0319 | Right, chrome |

| PART # | DESCRIPTION |
|---|---------------|
| FOR 01-17 TWIN CAM DELPHI EFI MODELS, 99-06 TWIN CAM CV CARB MODELS(EXCEPT 08-16 FLHT/ FLHR/ FLHX/ FLTR/H-D TRIKE, 16-17 SOFTAIL, 14-15 FLSTNSE, 13-14 FXSBSE, 11-12 FLSTSE, 16-17 FXDLS MODELS) | |
| 1014-0320 | Left, black |
| 1014-0322 | Right, black |
| 1014-0321 | Left, chrome |
| 1014-0323 | Right, chrome |
| FOR 91-22 XL MODELS (EXCEPT 21-22 SPORTSTER S/ RH1250S) | |
| 1014-0324 | Left, black |
| 1014-0326 | Right, black |
| 1014-0325 | Left, chrome |
| 1014-0327 | Right, chrome |



ALTERNATING BRAKE STROBE MODULES

- Brake strobe module alerts rear traffic
- Compatible with add-on custom LED lighting
- Does not affect OEM rear brake lights
- Plug-and-play technology



| PART # | FITS MODEL |
|------------------|---|
| 2050-0461 | For 14-22 FLHX/FLHXS/FLHXSE/FLHXST/FLTRX/FLTRXSE/FLTRXS/FLTRXST/FLTRK/FLTRKSE/FLTRU/FLTRUSE/FLHT/FLHTCU/FLHTCUL/FLHTK/FLHTKL/FLHTKSE/FLHR/FLTRXSE/FLHRXS models |
| 2050-0462 | For 96-17 SOFTAIL models (Except FXSB/FXCW/FXCWC/FLSTSE models) |
| 2050-0463 | For 10-13 FLHX/FLTRX (Does not fit CVO models) |
| 2050-0464 | For all 12VDC negative ground systems |



2020-2008



2020-2009



KURYAKYN

TRACER REAR SADDLEBAG LIGHTS

- Provide red run, turn and brake lighting
- Clean, fully diffused, solid LED illumination with no dots or shadowing
- Plug-and-play installation, no drilling required
- Low-profile design installs beneath saddlebag lids
- Sold in pairs

FOR 14-21 FLHT/FLHR/FLHX/FLTRX/FLTRU/FLTRK AND H-D FL TRIKE MODELS (14-21 FLHR/CVO MODELS RUN/TURN ONLY)

| PART # | DESCRIPTION | PART # | DESCRIPTION |
|-----------|-------------|-----------|-------------|
| 2020-2008 | Red | 2020-2009 | Smoke |

ADJUSTABLE DROP MIRROR MOUNTS

- Black anodized billet construction
- Delivers 180° of adjustability for stock batwing fairing-mounted mirrors
- Relocates factory fairing-mounted mirrors up, down or even further out
- Sold in pairs



| PART # | DESCRIPTION |
|-----------|------------------------------|
| 0640-1524 | For 06-13 FLHX/FLHXXX models |



BRAKE PEDALS

- Accepts stock pad
- Measures 9⁵/₈" L; smooth finish
- Sold each



| PART # | DESCRIPTION | PART # | DESCRIPTION |
|---|-------------|-----------|-------------|
| FOR 02-07 FLHT/FLHX/FLTR/FLHR MODELS; REPL. OEM #42407-02 | | | |
| 1610-0611 | Chrome | 1610-0613 | Chrome |
| 1610-0612 | Gloss black | 1610-0614 | Gloss black |
| FOR 08-13 FLHT/FLHTK/FLHX/FLTR/FLHR MODELS; REPL. OEM #42407-08 | | | |
| 1610-0613 | Chrome | 1610-0614 | Gloss black |



2401-0966



2401-0969



2401-0973



2401-0982



2401-0984



2401-0986



2401-0990

M-EIGHT BOLT KITS

- Engine kits include bolts for clutch cover, transmission side and top covers, starter, timer cover, lifter block, transmission bearing housing, rocker cover, outer primary and crankcase

CHROME-PLATED

| DESCRIPTION | FITMENT | KNURLED PART # | SMOOTH PART # |
|--|---|---------------------------|---------------------------|
| Engine bolt kit | For 17-21 FLHT/FLHR/FLHX/FLTRX/FLTRU/FLTRK, FLHTCUTG/FLRT | 2401-0966 | 2401-0967 |
| Lifter block bolt kit | For 17-21 M-Eight (all) | 2401-0968 | 2401-0969 |
| Rocker cover bolt kit | For 17-21 M-Eight (all) | 2401-0970 | 2401-0971 |
| Crankcase bolt kit | For 17-21 FLHT/FLHR/FLHX/FLTRX/FLTRU/FLTRK | 2401-0972 | 2401-0973 |
| Cam cover bolt kit | For 17-21 M-Eight (all) | 2401-0974 | 2401-0975 |
| Timer cover bolt kit (button-head Torx) | For 17-21 M-Eight (all) | - | 2401-0976 |
| Starter bolt kit | For 17-21 M-Eight (all) | 2401-0977 | 2401-0978 |
| Transmission side cover bolt kit | For 17-21 FLHT/FLHR/FLHX/FLTRX/FLTRU/FLTRK | 2401-0979 | 2401-0980 |
| Transmission bearing housing bolt kit | For 17-21 M-Eight (all) | 2401-0981 | 2401-0982 |
| Handlebar controls bolt kit | For 17-21 FLHT/FLHR/FLHX/FLTRX/FLTRU/FLTRK | 2401-0983 | 2401-0984 |
| Rear brake control bolt kit | For 17-21 M-Eight (all) | 2401-0985 | 2401-0986 |
| Transmission top cover bolt kit | For 17-21 M-Eight (all) | 2401-0987 | 2401-0988 |
| Outer primary bolt kit | For 17-21 FLHT/FLHR/FLHX/FLTRX/FLTRU/FLTRK | 2401-0989 | 2401-0990 |
| Clutch cover bolt kit (button-head) Torx | For 17-21 M-Eight (all except 19-21 Softail) | - | 2401-0991 |



M-EIGHT BOLT KITS (CONT)

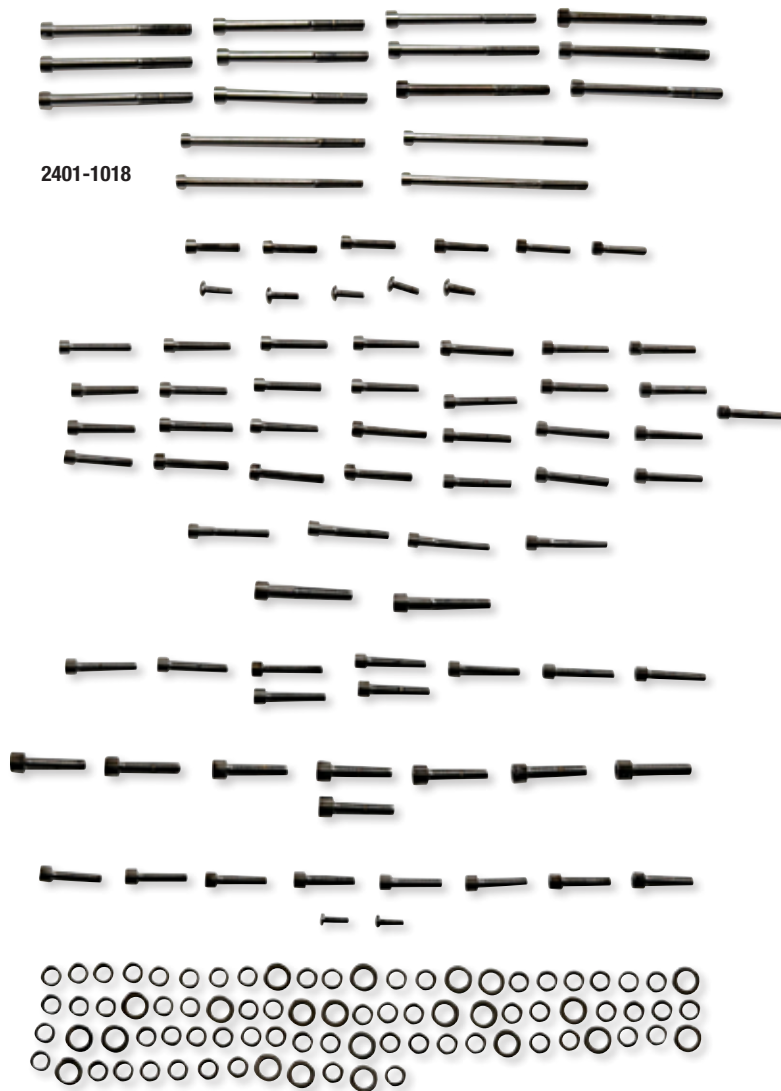

2401-1018



2401-1027



2401-1037



2401-1041

BLACK CHROME-PLATED

| DESCRIPTION | FITMENT | KNURLED PART # | SMOOTH PART # |
|--|---|---------------------------|---------------------------|
| Engine bolt set | For 17-21 FLHT/FLHR/FLHX/FLTRX/FLTRU/FLTRK, FLHTCUTG/FLRT | 2401-1017 | 2401-1018 |
| Lifter block bolt kit | For 17-21 M-Eight (all) | 2401-1019 | 2401-1020 |
| Rocker cover bolt kit | For 17-21 M-Eight (all) | 2401-1021 | 2401-1022 |
| Crankcase bolt kit | For 17-21 FLHT/FLHR/FLHX/FLTRX/FLTRU/FLTRK | 2401-1023 | 2401-1024 |
| Cam cover bolt kit | For 17-21 M-Eight (all) | 2401-1025 | 2401-1026 |
| Timer cover bolt kit | For 17-21 M-Eight (all) | 2401-1027 | - |
| Starter bolt kit | For 17-21 M-Eight (all) | 2401-1028 | 2401-1029 |
| Transmission side cover bolt kit | For 17-21 FLHT/FLHR/FLHX/FLTRX/FLTRU/FLTRK | 2401-1030 | 2401-1031 |
| Transmission bearing housing bolt kit | For 17-21 M-Eight (all) | 2401-1032 | 2401-1033 |
| Handlebar controls bolt kit | For 17-21 FLHT/FLHR/FLHX/FLTRX/FLTRU/FLTRK | 2401-1034 | 2401-1035 |
| Rear brake control bolt kit | For 17-21 FLHT/FLHR/FLHX/FLTRX/FLTRU/FLTRK | 2401-1036 | 2401-1037 |
| Transmission top cover bolt kit | For 17-21 M-Eight (all) | 2401-1038 | 2401-1039 |
| Outer primary bolt kit | For 17-21 FLHT/FLHR/FLHX/FLTRX/FLTRU/FLTRK | 2401-1040 | 2401-1041 |
| Clutch cover bolt kit (button-head Torx) | For 17-21 M-Eight (all except 19-21 Softail) | - | 2401-1042 |



2401-0562



2401-0565

2401-0570

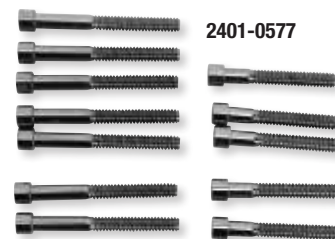

2401-0577

BLACK CHROME SOCKET-HEAD BOLT SETS

- Available in either knurled or smooth polished head styles
- Complete motor sets for Big Twin include bolts for primary, cam, cam sensor, derby, rocker box, transmission top, transmission side, lifter block and clutch covers
- Complete motor sets for XL include bolts for primary, cam, derby, lifter block, points cover, rocker box and engine case

| DESCRIPTION | FITMENT | KNURLED PART # | SMOOTH PART # |
|---------------------|--|----------------|---------------|
| FOR BIG TWIN | | | |
| Complete motor set | For 07-16 FLHT/FLHR/FLHX/FLTR | 2401-0564 | 2401-0565 |
| Complete motor set | For 07-17 FXST/FLST/FXD | 2401-0562 | 2401-0563 |
| Primary cover set | For 07-16 FLHT/FLHR/FLHX/FLTR | 2401-0570 | 2401-0571 |
| Primary cover set | For 07-17 FXST/FLST/FXD | 2401-0568 | - |
| Cam cover set | For 99-17 Twin Cam | 2401-0572 | 2401-0573 |
| FOR XL | | | |
| Complete motor set | For 04-21 XL (except 21 Sportster S/RH1250S) | 2401-0566 | - |
| Primary cover set | For 04-21 XL (except 21 Sportster S/RH1250S) | 2401-0574 | 2401-0575 |
| Cam cover set | For 04-21 XL (except 21 Sportster S/RH1250S) | 2401-0576 | 2401-0577 |

MOTOR BOLT SETS

- Chrome socket-head bolt set, available in either knurled or smooth polished head styles
- Includes socket-head bolts for cam, primary, point, clutch, inspection and chain covers, lifter base, inner primary, top front and rear motor mounts, timing plug and header mount screws

| FITMENT | KNURLED PART # | SMOOTH PART # |
|------------------------------------|----------------|---------------|
| For 77-84 FX, FL (except FXR, FLT) | DS-190766 | DS-190766S |
| For 70-76 FX, FL | - | DS-190767S |
| For 77-E84 XL | DS-190760 | DS-190760S |
| For 71-76 XL | DS-190761 | DS-190761S |
| For 87-94 FXR | DS-190870 | - |

DS-190766





2401-0765



2401-0760



2401-0768



2401-0770



2401-0774

CHROME SOCKET-HEAD BOLT SETS

- Socket-head bolt sets to meet virtually and custom need
- Complete motor sets for 07 and later Big Twin include bolts for primary, cam, cam sensor, derby, rocker box, transmission top, transmission side, lifter block and clutch covers
- Complete motor sets for 04 and later XL include bolts for primary, cam, derby, lifter block, points cover, rocker box and engine case
- Complete motor sets for 86-03 XL include bolts for cam, primary, generator, sprocket, rocker box, top motor mount, lifter base and point cover
- Available in both knurled and smooth polished head styles



2401-0778



2401-0782



DS-190863



2401-0785

| DESCRIPTION | FITMENT | KNURLED PART # | SMOOTH PART # |
|---|--|----------------|---------------|
| Complete motor set | For 07-16 FLHT/FLHR/FLHX/FLTR | 2401-0764 | 2401-0765 |
| Complete motor set | For 07-17 FXST/FLST/FXD | 2401-0762 | 2401-0763 |
| Complete motor set | For 06 FXD | 2401-0760 | 2401-0761 |
| Cam cover set | For 99-17 Twin Cam | - | DS192396 |
| Derby cover set (button-head Torx) | For 99-17 Twin Cam | - | 2401-0768 |
| Engine case set | For 99-04 Twin Cam | - | DS192398 |
| Handlebar clamp (not pullbacks) 1 1/4" L | For 99-17 Twin Cam | DS-190717 | DS-190717S |
| Handlebar lever mount and master cylinder cover | For 99-17 Twin Cam (except 08-14 Dressers) | DS-190716 | - |
| License plate bolt mount set | For all models | DS-190726 | - |
| Lifter base bolt kit | For 99-17 Twin Cam | - | DS192397 |
| Primary cover set | For 07-16 FLHT/FLHR/FLHX/FLTR | 2401-0771 | 2401-0772 |
| Primary cover set | For 07-17 FXST/FLST/FXD (except FXCW/C, FXSB/SE) | 2401-0769 | 2401-0770 |
| S&S Super-B air cleaner and carb | For S&S carbs | DS-190795 | - |
| Side cover set | For 07-16 FLHT/FLHR/FLHX/FLTR | 2401-0775 | 2401-0776 |
| Side cover set | For 07-17 FXST/FLST/FXD | 2401-0773 | 2401-0774 |
| Transmission side cover | For 99-06 Twin Cam | DS-190382 | DS-190382S |
| Transmission end cover and bearing support plate | For 00-06 FXST/FLST; 99-05 FXDWG | DS-190881 | DS-190881S |
| Complete motor set | For 04-21 XL (except 21 Sportster S/RH1250S) | 2401-0766 | 2401-0767 |
| Complete motor set | For 91-03 XL | DS-190874 | DS-190874S |
| Complete motor set | For 86-90 XL | DS-190805 | - |
| Cam, crankcase, sprocket cover and rear master cylinder mount | For 91-03 XL | - | DS-190878S |
| Cam, primary, sprocket cover and oil check screw | For 86-90 XL | DS-190798 | DS-190798S |
| Cam cover set | For 04-21 XL (except 21 Sportster S/RH1250S) | 2401-0777 | 2401-0778 |
| Cam cover set | For 91-03 XL | DS-190768 | DS-190768S |
| Cam cover set | For 86-90 XL | DS-190875 | - |
| Derby cover set (button-head Torx) | For 04-21 XL (except 21 Sportster S/RH1250S) | - | 2401-0779 |
| Handlebar clamp (not pullbacks) 1 1/4" long | For 86-20 XL | DS-190717 | DS-190717S |
| Handlebar lever mount and master cylinder cover | For 86-03 XL | DS-190716 | - |
| Lifter block kit | For 04-21 XL (except 21 Sportster S/RH1250S) | - | 2401-0781 |
| Motor mount set | For 91-03 XL | - | DS-190877S |
| Point cover set (button-head Torx) | For 04-21 XL (except 21 Sportster S/RH1250S) | 2401-0782 | - |
| Point cover set (button-head) | For 86-03 XL | DS-190871 | - |
| Primary cover set | For 04-21 XL (except 21 Sportster S/RH1250S) | 2401-0783 | 2401-0784 |
| Primary, sprocket cover and shifter | For 91-03 XL | DS-190863 | DS-190863S |
| Rocker box mount w/ washers | For 86-03 XL | DS-190813 | DS-190813S |
| Side cover set | For 04-21 XL (except 21 Sportster S/RH1250S) | 2401-0785 | 2401-0786 |
| Triple tree pinch bolts | For 86-E87 XL | DS-190743 | - |



DS-190398



DS-190873



DS-190870S



DS-190879



INDIVIDUAL CHROME SOCKET-HEAD BOLT SETS

- Socket-head bolt sets to meet virtually any custom need
- Available in both knurled and smooth polished head styles



DS-190740



DS-190743

| DESCRIPTION | FITMENT | KNURLED PART # | SMOOTH PART # |
|---|---|---------------------------|----------------------------|
| S&S Super-B A/C and carb | S&S carbs | DS-190795 | - |
| Bolts for lifter bases | L76-99 Big Twin | DS-190680 | - |
| Bolts for lifter bases | 36-E76 Big Twin | DS-190681 | - |
| Cam cover set | 93-99 Big Twin | DS-190398 | DS-190398S |
| Cam cover set | 87-92 Big Twin | DS-190866 | DS-190868 |
| Cam, primary, trans., inspection, derby cover set | 89-93 FXST/FLST; 91-93 Dyna | DS-190873 | DS-190873S |
| Cam, primary, trans., inspection, derby cover set | 87-88 FXST/FLST | - | DS-190819S |
| Cam, primary, trans., inspection, derby cover set | 87-94 FXR | DS-190818 | DS-190818S |
| Cam, primary, trans., inspection, derby cover set | 84-86 FLT; 84-86 FXR/FXRS | DS-190758 | DS-190758S |
| Complete motor set | 87-94 FXR/FLT | DS-190870 | DS-190870S |
| Complete motor set | 89-93 FXST/FLST | DS-190869 | DS-190869S |
| Complete motor set | 87-88 FXST/FLST | - | DS-190814S |
| Derby cover set (button-head Torx) | 99 FXST/FLST | - | 2401-0768 |
| Derby, inspection and primary covers | 89-98 FXST/FLST; 93-98 FXDWG (inner and outer covers) | DS-190879 | DS-190879S |
| Disc brake caliper mount, front (dual disc) | 77-83 XL, Big Twin | DS-190706 | - |
| Generator | 71-84 XL | DS-190787 | - |
| Handlebar clamp (not pullbacks) 1 1/4" long | 74-00 models | DS-190717 | DS-190717S |
| Handlebar lever mount and master cylinder cover | 96-00 Big Twin | DS-190716 | - |
| Handlebar lever mount and master cylinder cover | 73-81 models | DS-190719 | - |
| Handlebar lever mount and master cylinder cover | 96-99 Evolution Big Twin | DS-190716 | - |
| Kicker cover | 36-86 FX/FL | DS-190741 | DS-190741S |
| License plate mount | All models | DS-190726 | - |
| Lifter base bolt kit | 84-99 Evolution Big Twin | DS-190680 | - |
| Lifter base bolt kit | 36-47 Big Twin | DS-190681 | - |
| Motor mount set | 91-98 Dyna Glide, 91-99 Softail | DS-190880 | DS-190880S |
| Oil pump socket-head plug set | 81-94 FX/FL | DS-190783 | - |
| Point cover set (button head) | 79-99 Big Twin | DS-190871 | - |
| Point cover (button head) | 70-78 Big Twin, XL | DS-190872 | - |
| Rocker box mount w/ washers | 84-99 Evolution Big Twin | DS-190813 | DS-190813S |
| Rocker box set | 71-76 XL | DS-190994 | - |
| S&S Super-B air cleaner and carb | S&S carbs | DS-190795 | - |
| Transmission end cover and bearing support plate | 89-99 FXST/FLST; 93-98 FXDWG | DS-190881 | DS-190881S |
| Transmission mount (button head style) | 89-95 FXST/FLST | - | DS-190373 |
| Transmission side cover | 87-99 Big Twin | DS-190382 | DS-190382S |
| Transmission side cover | 80-86 Big Twin | - | DS-190394S |
| Transmission top cover | 59-79 Big Twin | DS-190740 | - |
| Transmission top cover | 87-99 Big Twin | - | DS-190395S |
| Triple tree pinch bolts | 85-E87 FX | DS-190743 | - |



DS-190600

COARSE-THREAD HEX-HEAD BOLT ASSORTMENT KIT

- All bolts are heat-treated for strength and have a show-chromed polished head
- Kit contains 1/4", 5/16" and 3/8" bolts in a variety of lengths; sold in 10-pack
- 7/16" and 1/2" bolts are not included in kit and must be purchased separately; sold in 5-pack
- Replacement packs of all sizes and lengths can be purchased individually

| PART # | DESCRIPTION |
|------------------------|--|
| DS-190600 | Coarse-thread hex-head bolt assortment kit |
| DS-190601 | 1/4"-20 x 5/8" |
| DS-190602 | 1/4"-20 x 3/4" |
| DS-190603 | 1/4"-20 x 7/8" |
| DS-190604 | 1/4"-20 x 1" |
| DS-190605 | 1/4"-20 x 1 1/4" |
| DS-190606 | 1/4"-20 x 1 1/2" |
| DS-190607 | 1/4"-20 x 1 3/4" |
| DS-190608 ¹ | 1/4"-20 x 2" |
| DS-190609 ¹ | 1/4"-20 x 2 1/4" |
| DS-190610 | 5/16"-18 x 5/8" |
| DS-190611 | 5/16"-18 x 3/4" |
| DS-190612 | 5/16"-18 x 7/8" |

| PART # | DESCRIPTION |
|------------------------|-------------------|
| DS-190613 | 5/16"-18 x 1" |
| DS-190614 | 5/16"-18 x 1 1/4" |
| DS-190615 | 5/16"-18 x 1 1/2" |
| DS-190616 | 5/16"-18 x 1 3/4" |
| DS-190617 ¹ | 5/16"-18 x 2" |
| DS-190618 ¹ | 5/16"-18 x 2 1/4" |
| DS-190619 | 3/8"-16 x 3/8" |
| DS-190620 | 3/8"-16 x 1" |
| DS-190621 | 3/8"-16 x 1 1/4" |
| DS-190622 | 3/8"-16 x 1 1/2" |
| DS-190623 | 3/8"-16 x 1 3/4" |
| DS-190624 | 3/8"-16 x 2" |
| DS192335 | 7/16"-14 x 1" |

| PART # | DESCRIPTION |
|-----------------------|-------------------|
| DS192336 | 7/16"-14 x 1 1/4" |
| DS192337 | 7/16"-14 x 1 1/2" |
| DS192338 | 7/16"-14 x 1 3/4" |
| DS192339 ¹ | 7/16"-14 x 2" |
| DS192340 | 1/2"-13 x 3/4" |
| DS192341 | 1/2"-13 x 1" |
| DS192342 | 1/2"-13 x 1 1/4" |
| DS192343 | 1/2"-13 x 1 1/2" |
| DS192344 ¹ | 1/2"-13 x 2" |
| DS192345 ¹ | 1/2"-13 x 2 1/4" |
| DS192346 ¹ | 1/2"-13 x 2 1/2" |
| DS192347 ¹ | 1/2"-13 x 2 3/4" |

¹ Bolts 2" and longer come as 5-pk.

FINE-THREAD HEX-HEAD BOLT ASSORTMENT KIT

- Contains 24 sizes of 24- and 28-thread hex-head bolts
- Each is heat-treated for strength and has a highly polished chromed head
- Sizes contained in the kit are also listed below and may be reordered in 10-pack

| PART # | DESCRIPTION |
|-----------|--|
| DS-190625 | Fine-thread hex-head bolt assortment kit |
| DS-190626 | 1/4"-28 x 5/8" |
| DS-190627 | 1/4"-28 x 3/4" |
| DS-190628 | 1/4"-28 x 7/8" |
| DS-190629 | 1/4"-28 x 1" |
| DS-190630 | 1/4"-28 x 1 1/4" |
| DS-190631 | 1/4"-28 x 1 1/2" |
| DS-190632 | 1/4"-28 x 1 3/4" |

| PART # | DESCRIPTION |
|------------------------|-------------------|
| DS-190633 ¹ | 1/4"-28 x 2" |
| DS-190634 ¹ | 1/4"-28 x 2 1/4" |
| DS-190635 | 5/16"-24 x 5/8" |
| DS-190636 | 5/16"-24 x 3/4" |
| DS-190637 | 5/16"-24 x 7/8" |
| DS-190638 | 5/16"-24 x 1" |
| DS-190639 | 5/16"-24 x 1 1/4" |
| DS-190640 | 5/16"-24 x 1 1/2" |
| DS-190641 | 5/16"-24 x 1 3/4" |

| PART # | DESCRIPTION |
|------------------------|-------------------|
| DS-190642 ¹ | 5/16"-24 x 2" |
| DS-190643 ¹ | 5/16"-24 x 2 1/4" |
| DS-190644 | 3/8"-24 x 3/4" |
| DS-190645 | 3/8"-24 x 1" |
| DS-190646 | 3/8"-24 x 1 1/4" |
| DS-190647 | 3/8"-24 x 1 1/2" |
| DS-190648 | 3/8"-24 x 1 3/4" |
| DS-190649 ¹ | 3/8"-24 x 2" |

¹ Bolts 2" and longer come as 5-pk.



DS-190614



DS-190623



DS-190639



DS-190558



DS-190560



DS-190572

DS-190578

FINE-THREAD SOCKET-HEAD BOLT ASSORTMENT KITS

- Kits contain 24 sizes of fine-thread chrome socket-head bolts ranging in size from 1/4" to 3/8"
- Available in either knurled or smooth polished head style
- Sizes contained in the kits are listed below and may be reordered in 10-pack

| DESCRIPTION | KNURLED PART # | SMOOTH PART # |
|------------------|------------------------|-------------------------|
| Complete kit | DS-190558 | DS-190558S |
| 1/4"-28 x 5/8" | DS-190559 | DS-190559S |
| 1/4"-28 x 3/4" | DS-190560 | DS-190560S |
| 1/4"-28 x 7/8" | DS-190561 | DS-190561S |
| 1/4"-28 x 1" | DS-190562 | DS-190562S |
| 1/4"-28 x 1 1/4" | DS-190563 | DS-190563S |
| 1/4"-28 x 1 1/2" | DS-190564 | DS-190564S |
| 1/4"-28 x 1 3/4" | DS-190565 | DS-190565S |
| 1/4"-28 x 2" | DS-190566 ¹ | DS-190566S ¹ |

| DESCRIPTION | KNURLED PART # | SMOOTH PART # |
|-------------------|------------------------|-------------------------|
| 1/4"-28 x 2 1/4" | DS-190567 ¹ | DS-190567S ¹ |
| 5/16"-24 x 5/8" | DS-190568 | DS-190568S |
| 5/16"-24 x 3/4" | DS-190569 | DS-190569S |
| 5/16"-24 x 7/8" | DS-190570 | DS-190570S |
| 5/16"-24 x 1" | DS-190571 | DS-190571S |
| 5/16"-24 x 1 1/4" | DS-190572 | DS-190572S |
| 5/16"-24 x 1 1/2" | DS-190573 | DS-190573S |
| 5/16"-24 x 1 3/4" | DS-190574 | DS-190574S |
| 5/16"-24 x 2" | DS-190575 ¹ | DS-190575S ¹ |

| DESCRIPTION | KNURLED PART # | SMOOTH PART # |
|-------------------|------------------------|-------------------------|
| 5/16"-24 x 2 1/4" | DS-190576 ¹ | DS-190576S ¹ |
| 3/8"-24 x 3/4" | DS-190577 | DS-190577S |
| 3/8"-24 x 1" | DS-190578 | DS-190578S |
| 3/8"-24 x 1 1/4" | DS-190579 | DS-190579S |
| 3/8"-24 x 1 1/2" | DS-190580 | DS-190580S |
| 3/8"-24 x 1 3/4" | DS-190581 | DS-190581S |
| 3/8"-24 x 2" | DS-190582 ¹ | DS-190582S ¹ |

¹ Bolts over 2" long are 5-pk. only.

DS-190533S



DS-190538



DS-190539S



DS-190540



DS-190548



DS-190551



DS-190555

COARSE-THREAD SOCKET-HEAD BOLT ASSORTMENT KITS

- Kits contain 24 sizes of coarse-thread chrome socket-head bolts ranging in size from 1/4" to 3/8"
- Available in either a knurled or a smooth polished head style
- Sizes contained in the kits are listed below and may be reordered in 10-pack

| DESCRIPTION | KNURLED PART # | SMOOTH PART # |
|------------------|------------------------|-------------------------|
| Complete kit | DS-190533 | DS-190533S |
| 1/4"-20 x 5/8" | DS-190534 | DS-190534S |
| 1/4"-20 x 3/4" | DS-190535 | DS-190535S |
| 1/4"-20 x 7/8" | DS-190536 | DS-190536S |
| 1/4"-20 x 1" | DS-190537 | DS-190537S |
| 1/4"-20 x 1 1/4" | DS-190538 | DS-190538S |
| 1/4"-20 x 1 1/2" | DS-190539 | DS-190539S |
| 1/4"-20 x 1 3/4" | DS-190540 | DS-190540S |
| 1/4"-20 x 2" | DS-190541 ¹ | DS-190541S ¹ |

| DESCRIPTION | KNURLED PART # | SMOOTH PART # |
|-------------------|------------------------|-------------------------|
| 1/4"-20 x 2 1/4" | DS-190542 ¹ | DS-190542S ¹ |
| 5/16"-18 x 5/8" | DS-190543 | DS-190543S |
| 5/16"-18 x 3/4" | DS-190544 | DS-190544S |
| 5/16"-18 x 7/8" | DS-190545 | DS-190545S |
| 5/16"-18 x 1" | DS-190546 | DS-190546S |
| 5/16"-18 x 1 1/4" | DS-190547 | DS-190547S |
| 5/16"-18 x 1 1/2" | DS-190548 | DS-190548S |
| 5/16"-18 x 1 3/4" | DS-190549 | DS-190549S |
| 5/16"-18 x 2" | DS-190550 ¹ | DS-190550S ¹ |

| DESCRIPTION | KNURLED PART # | SMOOTH PART # |
|-------------------|------------------------|-------------------------|
| 5/16"-18 x 2 1/4" | DS-190551 ¹ | DS-190551S ¹ |
| 3/8"-16 x 3/4" | DS-190552 | DS-190552S |
| 3/8"-16 x 1" | DS-190553 | DS-190553S |
| 3/8"-16 x 1 1/4" | DS-190554 | DS-190554S |
| 3/8"-16 x 1 1/2" | DS-190555 | DS-190555S |
| 3/8"-16 x 1 3/4" | DS-190556 | DS-190556S |
| 3/8"-16 x 2" | DS-190557 ¹ | DS-190557S ¹ |

¹ Bolts 2" and longer come as 5-pk.



DS-190583



DS-190585

DS-190590



DS-190598

#8 AND #10 FINE- AND COARSE-THREAD SOCKET-HEAD BOLT ASSORTMENT KITS

- Kits contain 15 sizes of fine- and coarse-thread #8 and #10 chrome socket-head bolts
- Available in either knurled or smooth polished head style
- May be reordered in 10-pack

| DESCRIPTION | KNURLED PART # | SMOOTH PART # |
|--------------|---------------------------|----------------------------|
| Complete kit | DS-190583 | DS-190583S |
| 8-32 x 1/2" | DS-190584 | DS-190584S |
| 8-32 x 7/8" | DS-190585 | DS-190585S |
| 10-24 x 3/8" | DS-190586 | DS-190586S |
| 10-24 x 1/2" | DS-190587 | DS-190587S |
| 10-24 x 5/8" | DS-190588 | DS-190588S |
| 10-24 x 3/4" | DS-190589 | DS-190589S |
| 10-24 x 1" | DS-190590 | DS-190590S |

| DESCRIPTION | KNURLED PART # | SMOOTH PART # |
|----------------|---------------------------|----------------------------|
| 10-24 x 1 1/4" | DS-190591 | DS-190591S |
| 10-24 x 1 1/2" | DS-190592 | DS-190592S |
| 10-24 x 1 3/4" | DS-190593 | DS-190593S |
| 10-24 x 2" | DS-190594 | DS-190594S |
| 10-32 x 1 1/2" | DS-190595 | DS-190595S |
| 10-32 x 3/4" | DS-190597 | DS-190597S |
| 10-32 x 7/8" | DS-190598 | DS-190598S |
| 10-32 x 1" | DS-190599 | - |

BUTTON-HEAD BOLT ASSORTMENT KIT

- Kit contains polished chrome button-head bolts ranging in size from 8-32 to 3/8"-24 in lengths up to 1"; sold in 10-pack
- 1/4", 5/16" and 3/8" bolts longer than 1" are not included, but may be ordered separately; sold in 5-pack
- Replacement packs are available for all sizes listed



DS-190837

| PART # | DESCRIPTION |
|---------------------------|----------------------------|
| DS-190995 | Button-head assortment kit |
| DS-190822 | 8-32 x 1/2" |
| DS-190823 | 8-32 x 5/8" |
| DS-190824 | 8-32 x 3/4" |
| DS-190825 | 10-24 x 1/2" |
| DS-190826 | 10-32 x 1/2" |
| DS-190827 | 10-32 x 3/4" |
| DS-190828 | 10-32 x 1" |
| DS-190829 | 1/4"-20 x 5/8" |
| DS-190830 | 1/4"-20 x 3/4" |

| PART # | DESCRIPTION |
|---------------------------|-------------------|
| DS-190831 | 1/4"-20 x 7/8" |
| DS-190832 | 1/4"-20 x 1" |
| DS192320 | 1/4"-20 x 1 1/4" |
| DS192321 | 1/4"-20 x 1 1/2" |
| DS192322 | 1/4"-20 x 1 3/4" |
| DS192323 | 1/4"-20 x 2" |
| DS-190833 | 1/4"-28 x 1 1/2" |
| DS-190834 | 1/4"-28 x 3/4" |
| DS-190835 | 1/4"-28 x 1" |
| DS-190836 | 5/16"-18 x 1 1/2" |

| PART # | DESCRIPTION |
|---------------------------|-------------------|
| DS-190837 | 5/16"-18 x 3/4" |
| DS-190838 | 5/16"-18 x 1" |
| DS192324 | 5/16"-18 x 1 1/4" |
| DS192325 | 5/16"-18 x 1 1/2" |
| DS192326 | 5/16"-18 x 2" |
| DS-190839 | 5/16"-24 x 3/8" |
| DS-190840 | 5/16"-24 x 1/2" |
| DS-190841 | 5/16"-24 x 1" |
| DS-190842 | 3/8"-16 x 3/4" |
| DS-190843 | 3/8"-16 x 1" |

| PART # | DESCRIPTION |
|---------------------------|------------------|
| DS192327 | 3/8"-16 x 1 1/4" |
| DS192328 | 3/8"-16 x 1 1/2" |
| DS192329 | 3/8"-16 x 1 3/4" |
| DS192330 | 3/8"-16 x 2" |
| DS192331 | 3/8"-16 x 2 1/4" |
| DS192332 | 3/8"-16 x 2 1/2" |
| DS192333 | 3/8"-16 x 2 3/4" |
| DS192334 | 3/8"-16 x 3" |
| DS-190844 | 3/8"-24 x 3/4" |
| DS-190845 | 3/8"-24 x 1" |



CHROME SOCKET-HEAD CAM/PRIMARY COVER BOLT SETS

- Available in knurled or smooth polished head style
- Provide a custom finish

DS-190873

| DESCRIPTION | FITMENT | KNURLED PART # | SMOOTH PART # |
|---|-----------------------------------|----------------|---------------|
| FOR BIG TWIN | | | |
| Cam, primary, trans., inspection, derby cover set | 89-93 FXST, FLST; 91-93 Dyna | DS-190873 | DS-190873S |
| Cam, primary, trans., inspection, derby cover set | 87-88 FXST, FLST | - | DS-190819S |
| Cam, primary, trans., inspection, derby cover set | 87-94 FXR | DS-190818 | DS-190818S |
| Cam, primary, trans., inspection, derby cover set | 80-86 FLT; 82-86 FXR, FXRS | DS-190758 | DS-190758S |
| Cam, primary, inspection, derby cover set | 70-84 FX, FL, FXWG (not FXR, FLT) | DS-190755 | DS-190755S |
| Cam, primary, inspection, derby cover set | 65-69 FX, FL | DS-190756 | - |
| Cam, primary, inspection, derby cover set | 36-64 FL | DS-190757 | - |
| Cam cover set | 93-99 Big Twin | DS-190398 | DS-190398S |
| Cam cover set | 87-92 Big Twin | DS-190866 | DS-190868 |
| Cam cover set | 70-84 Big Twin | DS-190865 | DS-190867 |
| Cam cover set | 36-69 FL | - | DS-190820 |
| Primary cover set only | 36-64 FL | DS-190821 | DS-190821S |
| Derby/inspection covers only | 36-64 FL | DS-190816 | - |
| FOR XL | | | |
| Cam, primary, sprocket cover and oil check screw | 77-85 XL | DS-190750 | DS-190750S |
| Primary cover set only | 77-85 XL | - | DS-190392S |
| Cam, primary and oil check screw | 71-76 XL | DS-190751 | DS-190751S |
| Primary cover set only | 71-76 XL | - | DS-190391S |
| Cam and primary side covers w/ special tapered heads and oil fill check screw | 67-70 XLH; 70 XLCH | DS-190753 | - |
| Cam and primary covers w/ special tapered head and oil fill check screw | 57-69 XLCH | DS-190752 | - |

7/16" AND 1/2" COARSE-THREAD SOCKET-HEAD BOLT KITS

- All socket-head bolts are chrome-plated with smooth polished heads
- Kits are available in 7/16" or 1/2" and include one 5-pack of each length of bolt listed below
- Replacement bolts available; sold in 5-pack

DS192307



| DESCRIPTION | 7/16" | 1/2" | DESCRIPTION | 7/16" | 1/2" | DESCRIPTION | 7/16" | 1/2" |
|-------------|----------|----------|-------------|----------|----------|-------------|----------|----------|
| 3/4" | DS192300 | DS192309 | 1 3/4" | DS192299 | DS192313 | 2 3/4" | DS192307 | DS192317 |
| 1" | DS192301 | DS192310 | 2" | DS192304 | DS192314 | 3" | DS192308 | DS192318 |
| 1 1/4" | DS192302 | DS192311 | 2 1/4" | DS192305 | DS192315 | 3 1/4" | - | DS192319 |
| 1 1/2" | DS192303 | DS192312 | 2 1/2" | DS192306 | DS192316 | | | |

DS192348



COUNTERSUNK SOCKET-HEAD BOLT ASSORTMENT

- Kit contains 24 sizes of bolts ranging from 8-32 to 3/8"-16
- All bolt heads are highly polished, then chrome-plated
- May be reordered in 10-pack

DS192350



DS192298

| PART # | DESCRIPTION | PART # | DESCRIPTION | PART # | DESCRIPTION | PART # | DESCRIPTION |
|----------|----------------|----------|----------------|----------|------------------|----------|-------------------|
| DS192348 | Assortment kit | DS192354 | 10-32 x 3/8" | DS192360 | 1/4"-20 x 1" | DS192366 | 5/16"-18 x 1 1/4" |
| DS192349 | 8-32 x 1/2" | DS192355 | 10-32 x 1/2" | DS192361 | 1/4"-20 x 1 1/4" | DS192367 | 5/16"-24 x 5/8" |
| DS192350 | 8-32 x 5/8" | DS192356 | 10-32 x 3/4" | DS192362 | 5/16"-18 x 1/2" | DS192368 | 5/16"-24 x 3/4" |
| DS192351 | 8-32 x 3/4" | DS192357 | 1/4"-20 x 1/2" | DS192363 | 5/16"-18 x 5/8" | DS192369 | 5/16"-24 x 1" |
| DS192352 | 10-24 x 1/2" | DS192358 | 1/4"-20 x 5/8" | DS192364 | 5/16"-18 x 3/4" | DS192298 | 3/8"-16 x 3/4" |
| DS192353 | 10-24 x 3/4" | DS192359 | 1/4"-20 x 3/4" | DS192365 | 5/16"-18 x 1" | DS192297 | 3/8"-16 x 1" |



DS-190850

CHROME ACORN NUT ASSORTMENT KIT

- Complete kit features fine and coarse threads, ranging from size #10 to 1/2"
- Comes in a plastic case with separate compartments for each size nut
- Each size contained in kit is also individually listed below and may be reordered in 10-pack, except 1/2" sizes which are 5-pack

| PART # | DESCRIPTION | PART # | DESCRIPTION |
|-----------|----------------|-----------|-------------|
| DS-190850 | Assortment kit | DS-190855 | 5/16"-18 |
| DS-190851 | 10-24 | DS-190856 | 5/16"-24 |
| DS-190853 | 1/4"-20 | DS-190857 | 3/8"-16 |
| DS-190854 | 1/4"-28 | DS-190858 | 3/8"-24 |

| PART # | DESCRIPTION |
|-----------|-----------------|
| DS-190860 | 7/16"-20 |
| DS-190861 | 1/2"-13 (5-pk.) |

CHROME WASHER AND HEX NUT ASSORTMENT KIT

- Kit contains three sizes of flat washers, three sizes of lock washers and six assorted sizes of standard-thread hex nuts – all brilliantly chromed
- Sizes contained in kit are also listed individually below and may be reordered in 100-pack

| PART # | DESCRIPTION | PART # | DESCRIPTION |
|-----------|--------------------|-----------|--------------------|
| DS-190650 | Assortment kit | DS-190655 | 5/16" flat washers |
| DS-190651 | 1/4" lock washers | DS-190656 | 3/8" flat washers |
| DS-190652 | 5/16" lock washers | DS-190657 | 1/4"-20 hex nuts |
| DS-190653 | 3/8" lock washers | DS-190658 | 1/4"-28 hex nuts |
| DS-190654 | 1/4" flat washers | DS-190659 | 5/16"-18 hex nuts |

DS190655



DS-190661

| PART # | DESCRIPTION |
|-----------|------------------|
| DS-190661 | 3/8"-16 hex nuts |
| DS-190662 | 3/8"-24 hex nuts |

CHROME NYLON INSERT NUT ASSORTMENT KIT

- Contains 11 sizes of coarse- and fine-thread chrome nylon insert nuts
- Sizes are listed below and may be reordered in 10-pack

| PART # | DESCRIPTION | PART # | DESCRIPTION |
|-----------|----------------|-----------|-------------|
| DS-190521 | Assortment kit | DS-190525 | 1/4"-28 |
| DS-190522 | 10-24 | DS-190526 | 5/16"-18 |
| DS-190523 | 10-32 | DS-190527 | 5/16"-24 |
| DS-190524 | 1/4"-20 | DS-190528 | 3/8"-16 |

DS-190529



| PART # | DESCRIPTION |
|-----------|-------------|
| DS-190529 | 3/8"-24 |
| DS-190530 | 7/16"-14 |
| DS-190531 | 7/16"-20 |
| DS-190532 | 5/8"-18 |



DS-190740



FUEL PUMP TOP PLATE HARDWARE KITS

- Include the proper amount of OEM replacement screws for fuel pump top plate
- Include washers

| PART # | DESCRIPTION | SIZE |
|------------------------|--|----------------------|
| 2401-0740 ¹ | For 02-07 FLHT/FLHR/FLHX/FLTR, 01-17 FXST/FLST models; repl. OEM #1311D | 8-32 x 1/2" (10-pk.) |
| 2401-0741 | For 04-17 Dyna; repl. OEM #1331 | 8-32 x 3/4" (12-pk.) |
| 2401-0742 | For 18-21 Softails, 07-21 XL (except 21 Sportster S/RH1250S); repl. OEM #1081A | 10-24 x 7/8" (5-pk.) |

¹ Will fit fuel sending unit on FXR models (5 required).

CHROME SOCKET-HEAD SCREWS FOR HALVES

- Faithful reproduction of the original clamp halves that secure the handlebar master cylinder or clutch control
- Sold in 4-pack



| PART # | DESCRIPTION |
|-----------|--|
| DS-190720 | For 99-17 Big-Twin, 96-13 XL (except 15-17 Softails, 08-17 Dressers and H-D FL Trike); repl. OEM #s 45044-96, 42808-04 |

CUSTOM HANDLEBAR AND RISER MOUNTING BOLTS

- Mounting bolts are available in hex- or Allen-head styles
- Choice of chrome or black finish

DS-430571



DS-430570



| PART # | DESCRIPTION |
|--------------------------------|---------------------------|
| CHROME ALLEN-HEAD BOLTS | |
| DS-430571 | 1/2"-13 x 2 3/4" (10-pk.) |
| DS-430588 | 1/2"-20 x 2 3/4" (10-pk.) |

| PART # | DESCRIPTION |
|-------------------------------|------------------------|
| BLACK ALLEN-HEAD BOLTS | |
| DS-430570 | 1/2"-13 x 1 1/2" (ea.) |
| DS-430589 | 1/2"-20 x 1 1/2" (ea.) |

2401-1563



2401-1565



HAND CONTROL SCREW KITS

- All hand control screws and washer available in one convenient pack
- Screws are chrome-plated or black zinc nickel-plated for corrosion resistance
- 1/4"-20 x 1 1/8" screws; repl. OEM #4132

| PART # | DESCRIPTION |
|-----------|--------------------------|
| 2401-1563 | Chrome-plated |
| 2401-1564 | Black zinc nickel-plated |

SWITCH HOUSING SCREW KITS

- All switch housing screws in one convenient pack
- Screws are chrome-plated or black zinc nickel-plated for corrosion resistance
- 10-24 x 1/2" screws; repl. OEM #3658

| PART # | DESCRIPTION |
|-----------|--------------------------|
| 2401-1562 | Black zinc nickel-plated |
| 2401-1565 | Chrome-plated |



SOFTAIL SWINGARM AXIS TUBE BOLT KIT

- Kit contains two chrome-plated 3/4"-16 x 3" grade-8 hex bolts and two chrome washers

| PART # | DESCRIPTION |
|-----------|---|
| DS-190901 | For 84-99 Softail; repl. OEM #s 4961 and 7142 |



SWINGARM PIVOT CAP/ HEADLIGHT VISOR HOLE PLUG

- Chrome-plated cap plugs the headlight mounting hole on 86-06 XL and 99-06 FX headlight visors
- Sold each

| PART # | DESCRIPTION |
|-----------|------------------------------------|
| DS-190982 | Repl. OEM #s 67865-89 and 67830-59 |

SHOCK MOUNT KITS FOR XL MODELS

- Specifically designed for Drag Specialties Premium Adjustable Shocks and Premium 10.5" Shocks on 04-20 XL applications only
- Use to ease installation and dress-up the mounting points when installing these shocks
- Includes 4 spacers .504" ID x 1.00" OD x .18" thick, 2 screws 1/2"-13 x 2 1/2" Torx button-head, and 2 screws 1/2"-20 x 2 3/4" Torx button-head



FOR 04-21 XL MODELS (EXCEPT 21 SPORTSTER S/RH1250S)

| PART # | DESCRIPTION | PART # | DESCRIPTION |
|-----------|-------------|-----------|-------------|
| 2401-0942 | Chrome | 2401-0943 | Black |

DISC BRAKE HUB MOUNTING BOLT KITS

- Grade-8 bolts
- Large-diameter button-head Torx® heads for increased load-bearing surface

2401-0889



DS-190466



FASTENER TYPE & SIZE

FRONT (HUB MOUNTED ROTORS)

| | | |
|-----------|--|---|
| 2401-0889 | For 99-21 Big Twin and 86-21 XL w/ cast wheel (except 21 Sportster S/RH1250S) (two required for dual disc) | Chrome, 5/16"-18 x 7/8" Torx® screw kit |
| 2401-0890 | For 99-21 Big Twin and 86-21 XL w/ cast wheel (except 21 Sportster S/RH1250S) (two required for dual disc) | Black chrome, 5/16"-18 x 7/8" Torx® screw kit |

REAR

| | | |
|-----------|---|--|
| DS190465 | For 99-09 Big Twin and 99-09 XL models w/ spoked wheels; repl. OEM #s 43567-92 (bolt) and #7778 (nut) | Chrome, 3/8"-16 x 1 1/4" Torx® screw and nut kit |
| DS-190466 | For 99-21 Big Twin and 92-20 XL models w/ cast/spoke wheels; repl. OEM #43567-92 | Chrome, 3/8"-16 x 1 1/4" Torx® screw kit |
| 2401-0891 | For 99-21 Big Twin and 92-21 XL w/ cast wheels (except 06-17 FXD and 21 Sportster S/RH1250S) | Chrome, 3/8"-16 x 1" Torx® screw kit |
| 2401-0892 | For 99-21 Big Twin and 92-20 XL w/ cast wheels (except 06-17 FXD) | Black chrome, 3/8"-16 x 1" Torx® screw kit |

REAR TURN SIGNAL MOUNTING KIT

- Chrome, hollow turn signal stalks with longer threads allow proper installation of OEM turn signals when installing any of our sissy bars
- 3 11/16" L
- Sold in pairs

| PART # | DESCRIPTION |
|-----------|--------------|
| DS-264005 | For 90-93 XL |





DS-190115

ACORN HARDWARE KITS

- Individual chrome acorn bolt and nut sets for specific applications

| PART # | DESCRIPTION |
|--------------------|------------------------------|
| FOR 36-99 BIG TWIN | |
| DS-190108 | Cylinder base nut set, 66-84 |
| DS-190115 | Head bolt set, 66-77 |

| PART # | DESCRIPTION |
|---------------------|------------------------------|
| FOR 57-85 XL MODELS | |
| DS-190130 | Rocker box bolt set, 57-76 |
| DS-190137 | Cylinder base nut set, 57-85 |

"CHROME WARE" ACORN NUTS

- Neatly packaged chrome acorn nuts in standard sizes
- One size per package
- Packaged quantities vary according to the thread size

| PART # | THREAD SIZE | QTY. |
|-----------|-------------|------|
| DS-190301 | 1/4"-28 | 5 |
| DS-190302 | 5/16"-24 | 4 |
| DS-190303 | 3/8"-24 | 3 |
| DS-190304 | 7/16"-20 | 2 |
| DS-190305 | 1/2"-20 | 1 |
| DS-190306 | 5/8"-18 | 1 |



DS190302

| PART # | THREAD SIZE | QTY. |
|-----------|-------------|------|
| DS-190320 | 10-24 | 5 |
| DS-190321 | 1/4"-20 | 5 |
| DS-190322 | 5/16"-18 | 4 |
| DS-190323 | 3/8"-16 | 3 |
| DS-190324 | 7/16"-14 | 2 |
| DS-190325 | 1/2"-13 | 1 |

DS-190341



"CHROME WARE" ACORN NUTS

- Neatly packaged chrome acorn nuts
- One size per package
- Packaged quantities vary according to the thread size

| PART # | THREAD SIZE | QTY. |
|-----------|-------------|------|
| DS-190340 | 6 mm | 5 |
| DS-190341 | 8 mm | 4 |
| DS-190342 | 10 mm | 3 |



LICENSE PLATE ACORN SET

- Each set includes four bolts, complete with custom acorn nuts
- Excellent for mounting license plates onto motorcycles

| PART # | DESCRIPTION |
|-----------|-------------------------|
| DS-190190 | License plate acorn set |



12-POINT CALIPER BOLT COVERS

- Quality chrome-plated steel bolt covers
- Polished and buffed to a mirror-like finish
- Sold in 4-pack



HEADBOLT COVERS

- Quality chrome-plated steel bolt covers
- Polished and buffed to a mirror-like finish

| PART # | DESCRIPTION |
|------------------|---|
| 2402-0072 | For 02-21 Big Twin models w/ stock calipers |

| PART # | DESCRIPTION |
|------------------|--|
| 2402-0073 | For 99-21 Twin Cam and 86-21 XL models (except 21 Sportster S/RH1250S) (4-pk.) |

HEADBOLT COVERS

- Machined from solid aluminum, then chrome-plated to a smooth finish
- Snap-on locking feature keeps covers in place
- Sold in 4-pack



ROCKER BOX BOLT COVERS

- Quality chrome-plated steel bolt covers
- Polished and buffed to a mirror-like finish
- Sold in 4-pack

| PART # | DESCRIPTION |
|------------------|---------------------|
| 2402-0083 | For all S&S engines |

| PART # | DESCRIPTION |
|------------------|--------------------|
| 2402-0071 | For 99-17 Twin Cam |

CHROME STEEL END PLUGS FOR ALLEN-HEAD BOLTS

- Made of steel, these will not fall out or come loose like plastic or aluminum with O-rings
 - Fit tightly and add that special finishing touch to the top of an Allen bolt
 - Assortment kit includes a convenient tray with 100 each of the 1/4", 5/16" and 3/8" size chrome plugs, plus three sample Allen bolts with plugs installed as sales tools
 - 10-pack is display packaged with a poly bag for individual sale
 - 100-pack refill bags available to keep your assortment kit fully stocked
- NOTE: Sizes given are thread size of the bolt – not the Allen wrench area.

DS-190979



DS-190992



DS-190998

| PART # | DESCRIPTION |
|------------------|--------------------------------|
| DS-190979 | Chrome end plug assortment kit |
| DS-190989 | 1/4" refill bag (100-pk.) |
| DS-190992 | 5/16" refill bag (100-pk.) |
| DS-190993 | 3/8" refill bag (100-pk.) |

| PART # | DESCRIPTION |
|------------------|---------------------------------------|
| DS-190998 | 1/4" chrome end plugs (10-pk.) |
| DS-190999 | 5/16" chrome end plugs (10-pk.) |
| DS-191000 | 3/8" chrome end plugs (10-pk.) |
| DS-191009 | 7/16"- 1/2" chrome end plugs (10-pk.) |



DS-190779



DS-190777



TIMING PLUG/OIL TANK DRAIN PLUG

- Chromed timing plug with socket head for most models
- Also fits oil tank drains on some models
- Size is 5/8"-18

| PART # | DESCRIPTION |
|-----------|--------------------------------|
| DS-190785 | Chrome socket-head timing plug |

SOCKET-HEAD ROCKER ARM SHAFT END PLUGS

- Available in chrome
- Sold in a set of four

| PART # | DESCRIPTION |
|-----------|--|
| DS-190779 | For 71-85 XL (1/2"-20); repl. OEM #17448-71A |
| DS-190777 | For 57-70 XL (5/16"-24); repl. OEM #17448-57 |



DS-190000



DS-190001



DS-190007



DS-190017

CHROME STEEL SPACER KIT

- Pre-cut, chromed spacers in 1/8", 1/4", 3/8", 1/2", 3/4" and 1" lengths
- Designed to be used with 1/4", 5/16" and 3/8" bolts
- Spacers with 1/4" and 5/16" bolt holes have .650" outer diameter

- Spacers with 3/8" bolt hole have .750" outer diameter
- Replacement packs available separately

| PART # | DESCRIPTION | PART # | DESCRIPTION | PART # | DESCRIPTION |
|-----------|-------------------------|-----------|----------------------|-----------|---------------------|
| DS-190000 | Chrome steel spacer kit | DS-190007 | 5/16" x 1/8" (5-pk.) | DS-190014 | 3/8" x 1/4" (5-pk.) |
| DS-190001 | 1/4" x 1/8" (5-pk.) | DS-190008 | 5/16" x 1/4" (5-pk.) | DS-190015 | 3/8" x 3/8" (5-pk.) |
| DS-190002 | 1/4" x 1/4" (5-pk.) | DS-190009 | 5/16" x 3/8" (5-pk.) | DS-190016 | 3/8" x 1/2" (5-pk.) |
| DS-190003 | 1/4" x 3/8" (5-pk.) | DS-190010 | 5/16" x 1/2" (5-pk.) | DS-190017 | 3/8" x 3/4" (5-pk.) |
| DS-190004 | 1/4" x 1/2" (5-pk.) | DS-190011 | 5/16" x 3/4" (5-pk.) | DS-190018 | 3/8" x 1" (5-pk.) |
| DS-190005 | 1/4" x 3/4" (5-pk.) | DS-190012 | 5/16" x 1" (5-pk.) | | |
| DS-190006 | 1/4" x 1" (5-pk.) | DS-190013 | 3/8" x 1/8" (5-pk.) | | |



CHROME INSIDE STAR WASHER ASSORTMENT KIT

- A complete assortment of chrome inside star washers in a handy tray
- Kit contains 10 sizes totaling 400 pieces
- Refill parts also available

| PART # | DESCRIPTION | PART # | DESCRIPTION | PART # | DESCRIPTION |
|-----------|----------------------|-----------|----------------|-----------|---------------|
| DS-190502 | Assortment kit | DS-190506 | 1/4" (50-pk.) | DS-190508 | 3/8" (50-pk.) |
| DS-190505 | #10 / 3/16" (50-pk.) | DS-190507 | 5/16" (50-pk.) | | |

7/8" OD WASHERS

- Tumbled, chrome-plated washers can be installed under luggage rack legs, saddlebag lid rails or anywhere else you need extra support
- Use to dress-up scratched or cracked areas due to drilling
- Sold in 4-pack

DS-190715



| PART # | DESCRIPTION |
|-----------|--------------------|
| DS-190715 | 1/4" ID washer set |

SPECIALTY CHROME WASHERS

- AN and USS washers have an outside diameter approximately 1/64" larger than the assembly bolt
- Flat washers are designed for custom applications where a desired inner/outer diameter and thickness are required



DS192372



DS192384



DS192387

| AN WASHERS | | USS WASHERS | |
|------------|----------------|-------------|----------------|
| PART # | DESCRIPTION | PART # | DESCRIPTION |
| DS192372 | 1/4" (50-pk.) | DS192381 | #10 (25-pk.) |
| DS192373 | 5/16" (50-pk.) | DS192382 | 1/4" (25-pk.) |
| DS192374 | 3/8" (50-pk.) | DS192383 | 5/16" (25-pk.) |
| | | DS192384 | 3/8" (25-pk.) |
| | | DS192385 | 7/16" (25-pk.) |
| | | DS192386 | 1/2" (25-pk.) |

| FLAT WASHERS | | | |
|--------------|--------|--------|-----------|
| PART # | ID | OD | THICKNESS |
| DS192387 | 15/32" | 29/32" | 1/8" |
| DS192390 | 15/32" | 15/36" | 5/64" |
| DS192391 | 17/32" | 1" | 1/16" |
| DS192392 | 17/32" | 1" | 11/64" |
| DS192393 | 13/32" | 7/8" | 1/8" |
| DS192394 | 11/32" | 1" | 5/64" |
| DS192395 | 7/16" | 11/16" | 5/16" |

CHROME WASHERS

- Lock washer kit includes 1/4" (10), 5/16" (10), 3/8" (10), 7/16" (2), 1/2" (2) and 5/8" (2), totaling 36 pieces
- Flat washer kit includes 1/4" (15), 5/16" (10) and 3/8" (10), totaling 35 pieces

| PART # | DESCRIPTION |
|-----------|-------------------------------|
| DS-190500 | Lock washer kit (36-pcs.) |
| DS-190501 | SAE flat washer kit (35-pcs.) |
| DS192378 | 7/16" SAE flat washer |
| DS192379 | 1/2" SAE flat washer |
| DS192380 | 9/16" SAE flat washer |

