



1800-2488



1800-2487

## SIDEWINDER 2-INTO-1 EXHAUST SYSTEMS

- Increased power and torque
- Stainless steel header construction
- High-flow catalytic converters
- Includes adapters that allow use of wide band or stock O<sub>2</sub> sensors
- Machined aluminum end cap
- Deep performance exhaust note
- Optional shadow Muffler kits fill the left-side cutout in extended saddlebags when running a Sidewinder 2:1 exhaust system (sold separately, see page 353 of the Parts Europe 2020 FatBook)
- Matched muffler body is 4,5" in diameter
- End cap is a mirror image match of the right-side 2:1 Sidewinder muffler end cap
- All necessary mounting hardware included

### PART #

### DESCRIPTION

FOR 17-20 FLHT/FLHR/FLHX/FLTRX/FLTRU

**1800-2488**

Chrome w/ black highlighted machined end cap

**1800-2487**

Black ceramic w/ black highlighted machined end cap

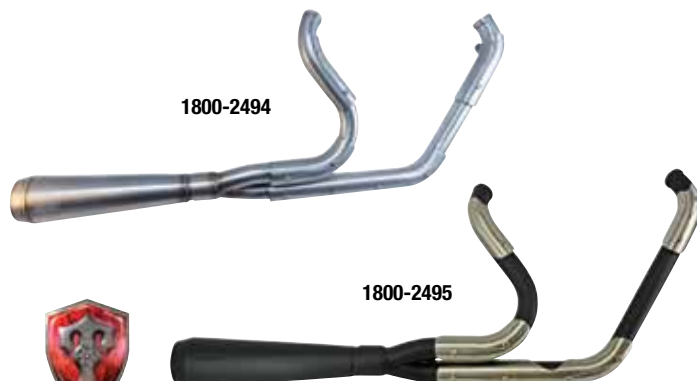

1800-2494

1800-2495



## ASSAULT 2-INTO-1 EXHAUST SYSTEMS

- Made from high-quality stainless steel, mandrel bent, then TIG-welded
- Includes custom heat shields with wire-tied fasteners for race-inspired look
- Double slip fit and gusset for additional strength
- O<sub>2</sub> ports included
- See page 411 of the Parts Europe 2020 FatBook for additional exhaust system applications

### PART #

### DESCRIPTION

FOR 00-17 FXS/FXST/FLS/FLST (EXCEPT 15-17 FXSB/FXSE, 09 FXSTSSE)

**1800-2494**

Stainless

**1800-2495**

Black/stainless



1210-2493



## REPLACEMENT REAR SPROCKETS FOR 530 CHAIN DRIVE CONVERSION KITS

- Heat-treated for added durability
- Black anodized finish
- See page 766 of the Parts Europe 2020 FatBook for complete conversion kits

### PART #

### DESCRIPTION

**1210-2493**

51-tooth rear sprocket

**1210-2494**

54-tooth rear sprocket



4405-0685



4405-0686



## ROKKER® 400W AMPLIFIER KITS

- Full range Class D amplifier with a 2-ohm load
- Two channels spec'd at 200W each
- Plug-n-play wiring
- Amplifier settings optimized for clarity and volume while on the highway
- Amplifier measures 18,5 cm x 12 cm x 44 mm (7<sup>1</sup>/<sub>4</sub>" x 4<sup>3</sup>/<sub>4</sub>" x 1<sup>3</sup>/<sub>4</sub>" )

PART #	DESCRIPTION
4405-0685	For 98-13 FLHT/FLHX/FLTR w/ stock or aftermarket radio
4405-0686	For 06-13 FLHTCU/FLHX/FLHTK
4405-0687	For 14-20 FLHTCU/FLHX/FLHTK

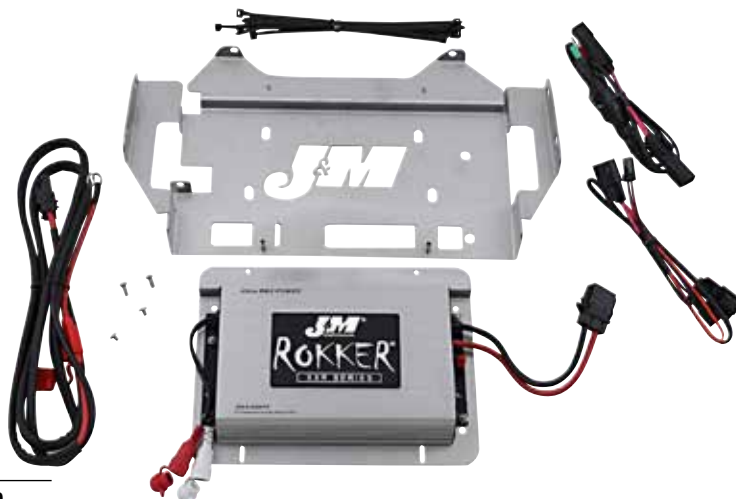

4405-0687



## SLC SIDE CARRIERS

- Precisely developed design allows for simple and secure mounting on the bike's original attachment points
- Quick-release mounting system allows side bags to be easily attached or removed
- Provides secure hold for side bags, side cases, adapter plates and universal side bracket number plates
- Available for both the left and right sides of the motorcycle
- Includes mounting hardware



1510-0896



1510-0893

FITS MODEL	LEFT PART #	RIGHT PART #
SOFTAIL		
For 18-20 FXBB	1510-0896	1510-0897
For 00-17 FLST/FLSTN/FLSTFB/FLSTC/FXSBSSE	1510-0890	1510-0891
For 07-17 FLSTF	1510-0894	1510-0895

FITS MODEL	LEFT PART #	RIGHT PART #
DYNA		
For all 09-17 FXDB/FXDWG/FXDL	1510-0888	1510-0889
For 08-17 FXDF	1510-0892	1510-0893
For 00-08 FXDB/FXDWG/FXDL	1510-0886	1510-0887



### PROFILER LS SEAT

- Narrow styling, a thin profile and low riding height
- Lattice stitch (LS) design infuses old-school lattice stitch retro styling with a modern twist
- Driver's portion features a unique blend of variable-density foam and GelCore™ technology that is the largest comfort advancement in motorcycle seating since the creation of suspension
- Supple SaddleHyde™ offers a combination of comfort, glove-soft leathery feel and weather-resistant, no-maintenance good looks

PART #	DESCRIPTION
0802-1420	For 18-20 FLDE/FLHC/FLHCS/FLSL



### KNUCKLE PROFILER SEAT

- Narrow styling, a thin profile and low riding height
- Features a unique blend of variable-density foam and GelCore™ that eases tailbone pressure and improves circulation
- Proprietary GelCore technology dampens, diverts and deflects energy from road shock and engine vibration for a smooth, comfortable ride
- Supple SaddleHyde™ offers a combination of comfort, glove-soft leathery feel and weather-resistant, no-maintenance good looks

PART #	DESCRIPTION
0802-1417	For 18-20 FLDE/FLHC/FLHCS/FLSL



### PROFILER SEAT

- Narrow styling, a thin profile and low riding height
- Driver's portion features GelCore™ pad for unsurpassed levels of comfort
- Supple SaddleHyde™ offers a combination of comfort, glove-soft leathery feel and weather-resistant, no-maintenance good looks
- Available in black



### PROFILER TR SEAT

- The Profiler series of seats provides the ultimate low-profile seat for two
- Saddlemen's proprietary GelCore™ technology provides unparalleled comfort
- Unique blend of variable-density seat foam and GelCore eases tailbone pressure and improves circulation
- Features narrow styling, a thin profile and a specially designed base that allows the seat to drop down for the lowest riding position possible
- Authentic true tuck-n'-roll construction, not a quick cross-stitch; seat is covered in genuine leather for a bold look

PART #	DESCRIPTION
0802-1419	For 18-20 FLDE/FLHC/FLHCS/FLSL



### PROFILER BW SEAT

- Slammed two-up seat features narrow styling, a thin profile and low riding height
- Seat design drops the rider down into the bike for the lowest riding position possible, while maintaining a high standard of comfort and support
- Unique blend of variable-density foam and GelCore™ eases tailbone pressure and improves circulation
- Contrasting-grain, basket-weave SaddleHyde™ cover
- Basket-weave pattern on driver's seat provides more breathability and extra grip if needed
- Basket-weave is sewn into the slender tail section to accent the low seat styling and profile

PART #	DESCRIPTION
0802-1418	For 18-20 FLDE/FLHC/FLHCS/FLSL



PART #	DESCRIPTION
0802-1416	For 18-20 FLDE/FLHC/FLHCS/FLSL



0810-2254



0810-2255

### 3/4 FRONT SOLO SEATS

- Gives the bike a cafe-racer style look
- Has a 10 cm (4") rise at the back of the seat for added support
- High-quality automotive-grade vinyl cover
- Molded polyurethane foam for maximum comfort and styling
- 5 mm (3/16") ABS thermoformed seat base for a perfect fit, with a carpeted bottom and rubber bumpers to protect paint
- Mounts just like the OEM seat; no additional hardware needed

PART #	DESCRIPTION
--------	-------------

FOR 18-20 SCOUT BOBBER MODELS

56 CM L OVERALL (28 CM L X 28,5 CM W FRONT) (23 CM L X 12,5 CM W REAR);  
22" L OVERALL (11" L X 11 1/4" W FRONT) (9" L X 5" W REAR)

0810-2254

Black, smooth

0810-2255

Black, diamond stitch



### BOBBER-STYLE FRONT SOLO SEATS

- Looks like a vintage spring solo seat, but is rigid-mounted
- High-quality automotive-grade vinyl cover
- Molded polyurethane foam for maximum comfort and styling
- 5 mm (3/16") ABS thermoformed seat base for a perfect fit, with a carpeted bottom and rubber bumpers to protect paint
- Works with the OEM driver backrest bar
- No added mounting hardware, mounts the same as the factory seat



0810-2256



0810-2257

PART #	DESCRIPTION
--------	-------------

FOR 18-20 SCOUT BOBBER MODELS

38 CM L OVERALL X 25,5 CM L X 32,5 CM W; (15" L OVERALL X 10" L X 12 3/4" W)

0810-2256

Smooth

0810-2257

Diamond stitch



### OVAL SISSY BAR PADS

- High-quality automotive-grade vinyl cover
- Designed to match Drag Specialties seats specifically
- Fits short, medium and tall H-D detachable sissy bars
- Measures 19 cm tall x 25,5 cm wide (7 1/2" tall x 10" wide)

**NOTE:** Pads mount with OEM hardware.

**NOTE:** The short bar and pad may not work with the OEM tall passenger pillion seats.



0822-0428



0822-0429



0822-0430

PART #	DESCRIPTION
--------	-------------

FOR 99-20 FLHR/FLHT/FLHX/FLTR MODELS W/ H-D DETACHABLE SISSY BARS  
(EXCEPT AIR WING SISSY BAR)

0822-0428

Double diamond, black stitch

0822-0429

Double diamond, silver stitch

0822-0430

Double diamond, red stitch



0601-5356



### 38 MM (1½") HAMMERHEAD HANDLEBARS

- For that T-Bar look and feel without having to modify your gauges
- Use the same mitered tip as the Grande Prime Ape handlebars
- 32 mm (1¼") clamping area with 89 mm (3½") on-center knurling
- Available in chrome or gloss black



0601-5361

CHROME PART #	GLOSS BLACK PART #	END RISE	WIDTH	CENTER WIDTH	PULLBACK
FOR 15-20 FLTRX/FLTRU/FLTRK, 18-20 FLHRXS					
0601-5356	0601-5357	30,5 cm (12")	77,5 cm (30½")	26,5 cm (10½")	14 cm (5½")
0601-5358	0601-5359	35,5 cm (14")	77,5 cm (30½")	26,5 cm (10½")	14 cm (5½")
0601-5360	0601-5361	40,5 cm (16")	77,5 cm (30½")	26,5 cm (10½")	14 cm (5½")



### FUSION ALLOY THROTTLE TUBE

- Durable 6061 aluminum
- Hard-anodized black finish
- Integrated PTFE sleeve delivers smooth throttle pull and return
- Geared for Indian Throttle-By-Wire housing

PART #	DESCRIPTION
0632-0855	For 18-20 Indian Chief and Touring models

0408-0392



**SLYFOX**  
AMERICAN MADE MOTORCYCLE PARTS

### CUSTOM 49 MM TRIPLE TREES

- CNC-machined 6061-T6 aluminum construction
- Zinc-plated steel stem
- Six lb lighter than stock trees
- Stock rakes include fork stop
- Accepts stock risers and bushings
- Compatible with OEM upper stem assembly and bearings

**NOTE:** FLTR models will require gauge relocation.

**NOTE:** Will require relocation of ignition switch.

**NOTE:** Not for use with fork boot covers/sliders.



0408-0393

PART #	DESCRIPTION
FOR 14-20 FLHT/FLHR/FLHX/FLTRX/FLTRU/FLTRK MODELS	
0408-0392	Raw
0408-0393	Black

## FEULING

Designers of world-class high-performance parts for your M-Eight engine. The new 472 Race Series camchest kit includes all necessary components to upgrade the camchest in one convenient package. Every part in this kit has been developed using extensive R&D research and the highest levels of quality control to ensure every part delivers maximum performance. When you want the best in engine upgrades for your American V-Twin, choose Feuling performance parts.



0925-1330

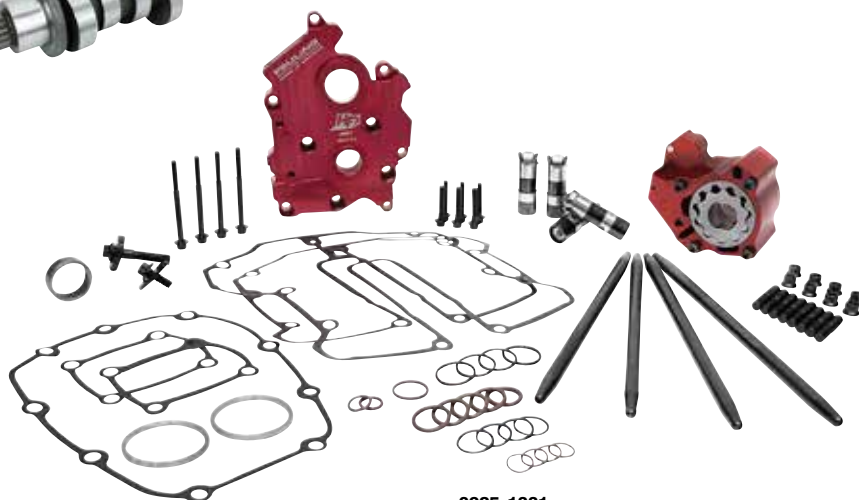

0925-1331



### 472 RACE SERIES® CAMCHEST KITS FOR M-EIGHT

- Feuling® complete camchest kits include all necessary components from top to bottom of the camchest conveniently packaged under one part
- These combination kits not only ensure each individual part is designed to work and function together, but to do so in total harmony
- These camchest kits take the guesswork out of the ordering process and provide the engine builder maximum reliability, peak performance and the coolest engine/oil temperatures obtainable
- Complete Camchest Kits include: Feuling® High Volume oil pump, High Flow camplate, 472 Reaper® Series camshafts, hydraulic roller lifters, fixed length pushrods, Timken®/Koyo® cam bearings, rocker arm studs/nuts, gaskets, O-rings, ARP® cam/crank fasteners, washers, moly paste and Loctite®
- Race Series® kits include a Race Series® oiling system (billet 7075 oil pump, Race Series® lifters, High Flow billet 7075 aluminum camplate)
- Billet 7075 aluminum oil pump, which is 50% harder and stronger than the factory pump, holding tighter tolerances under temperature, deeper scavenge kidneys over Fueling HP+ oil pump
- Deeper scavenge kidney ports over the HP+ series for even more scavenge flow volume
- Race Series® hydraulic lifters have a full 0,200" of total travel designed with a slower bleed-down rate to handle heavy valve spring pressures, increase engine rpm before valve float and feature increased roller clearance for steep ramped camshafts and clearance for the M-Eight front exhaust camshaft lobe flange
- 30% more pressure gear volume over stock for M-Eight Twin-Cooled motors
- 53% more scavenge gear volume over stock for M-Eight Twin-Cooled motors
- 27% more pressure and scavenge gear volume over stock for M-Eight Oil-Cooled motors
- 42% more scavenge volume with port sizing, matched passages and holes to the engine case for M-Eight Twin-Cooled motors and M-Eight Oil-Cooled motors
- 68% more oil volume to the crankshaft and connecting rod bearing for M-Eight Twin-Cooled™ motors and M-Eight Oil-Cooled motors
- 15-25 degree cooler engine temperatures for M-Eight Twin-Cooled™ motors and M-Eight Oil-Cooled motors
- 15-30 degree cooler oil temperatures for M-Eight Twin-Cooled™ motors and M-Eight Oil-Cooled motors
- 10-30 more psi of oil pressure for M-Eight Twin-Cooled™ motors and M-Eight Oil-Cooled motors
- Increase oil pressure, scavenge volume and engine oil flow
- Quieter and smoother engine operation
- Reduces wet sumping, blowby and oily air cleaners
- Magnets in oil pump to help protect gears and pressure relief valve
- Test results show 2 hp gain and 2 ft/lb. of TQ gain to the rear wheel on M-Eight
- Feuling test results show a 50% reduction of engine sump oil level
- For M-Eight Reaper® cam specs see chart

PART #	DESCRIPTION
<b>0925-1330</b>	For 17-20 M-Eight Oil-Cooled motors
<b>0925-1331</b>	For 17-20 M-Eight Twin-Cooled™ motors

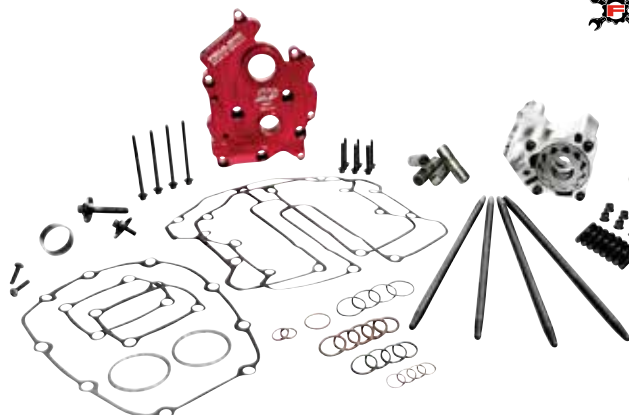

0925-1328

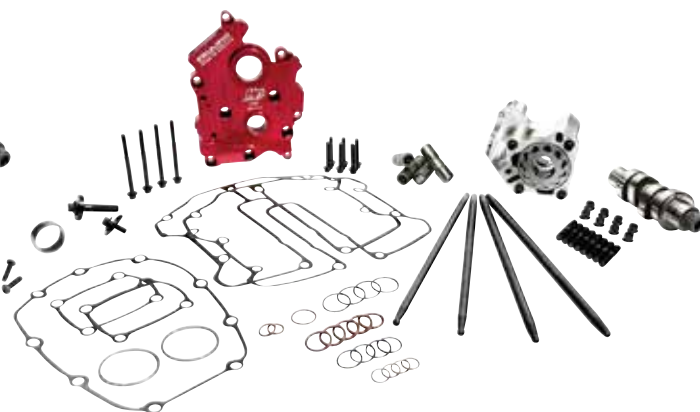

0925-1329

## 472 HP+ CAMCHEST KITS FOR M-EIGHT

- Quieter and smoother engine operation
- Increase oil pressure, scavenge volume and engine oil flow
- Eliminate wet sumping, blowby and oily air cleaners
- Heavy-duty 0,165" wall one-piece pushrods reduce valvetrain harmonics and increase valve lift
- Kits include: Feuling High Volume oil pump, High Flow billet camplate, 472 Reaper® series camshaft, hydraulic roller lifters, fixed length pushrods, Timken/Koyo cam bearing, rocker arm studs and nuts, gaskets, O-rings, ARP® cam/crank fasteners, washers, moly lube and Loctite®
- 30% more pressure gear volume over stock for M-Eight Twin-Cooled™ motors
- 53% more scavenge gear volume over stock for M-Eight Twin-Cooled™ motors
- 27% more pressure and scavenge gear volume over stock for M-Eight Oil-Cooled motors
- 42% more scavenge volume with port sizing, matched passages and holes to the engine case for M-Eight Twin-Cooled™ motors and M-Eight Oil-Cooled motors

- 68% more oil volume to the crankshaft and connecting rod bearing for M-Eight Twin-Cooled™ motors and M-Eight Oil-Cooled motors
- Feuling test results show a 50% reduction of engine sump oil level
- 15-25 degree cooler engine temperatures for M-Eight Twin-Cooled™ motors and M-Eight Oil-Cooled motors
- 15-30 degree cooler oil temperatures for M-Eight Twin-Cooled™ motors and M-Eight Oil-Cooled motors
- 10-30 more psi of oil pressure for M-Eight Twin-Cooled™ motors and M-Eight Oil-Cooled motors
- For M-Eight 472 Reaper® cam specs see chart

PART #	DESCRIPTION
<a href="#">0925-1328</a>	For 17-20 M-Eight Oil-Cooled motors
<a href="#">0925-1329</a>	For 17-20 M-Eight Twin-Cooled™ motors

GRIND	VALVE LIFT	OPEN	CLOSE	DURATION @ 0,050"	LIFT @ TDC	LOBE CENTERLINE
472 (CAM SPECS MEASURED IN THE ENGINE ON THE LIFTER @ 0,050" USING A 1.61 ROCKER ARM RATIO)						
Intake	0,468	8°	25°	213°	0,117"	98,5°
Exhaust	0,472	50,7°	7,75°	238°	0,110"	111,5°



## PUNISHER XL FOOTPEGS

- Constructed from CNC-machined 6061-T6 billet aluminum and designed to complement the technology and aesthetic of modern Harley-Davidson® motorcycles
- Stainless steel traction pins
- 4130 investment-cast chromoly clevis
- Stainless steel mounting hardware
- Available in polished or black finish
- Measure 2<sup>5</sup>/<sub>8</sub>" W x 4<sup>1</sup>/<sub>4</sub>" L
- Sold in pairs

PART #	DESCRIPTION
MALE-MOUNT FOOTPEGS	
<a href="#">1620-2174</a>	Polished
<a href="#">1620-2175</a>	Black



1620-2174



1620-2175



1620-2176

## PASSENGER FOOTPEG CLEVISES

- Allow mounting of any Biltwell footpegs on M-Eight/ELW passenger mounts
- Investment-cast chromoly steel construction
- Available in black or chrome finish
- Sold in pairs

PART #	DESCRIPTION
FOR 18-20 SOFTAILS/ELW MODELS	
<a href="#">1620-2176</a>	Black
<a href="#">1620-2177</a>	Chrome



1620-2177



0940-1911



0940-1910

## 10-GAUGE ROCKER BOX TOP COVERS

- CNC-machined from forged billet aluminum
- Drastically change the look of your engine
- Replace OEM top rocker box covers
- Include necessary gaskets and hardware
- Sold in pairs

### PART #

### DESCRIPTION

#### FOR 17-20 M-EIGHT MODELS

0940-1911

Black anodized

0940-1912

Titanium anodized

#### FOR 99-17 TWIN CAM MODELS

0940-1909

Black anodized

0940-1910

Titanium anodized



0940-1907



0940-1906

## 10-GAUGE LIFTER BLOCK COVERS

- Machined from 6061-T6 billet aluminum
- Chrome hardware included
- Sold in pairs

### PART #

### DESCRIPTION

#### FOR 17-20 M-EIGHT MODELS

0940-1907

Black anodized

0940-1908

Titanium anodized

#### FOR 99-17 TWIN CAM MODELS

0940-1905

Black anodized

0940-1906

Titanium anodized



0925-1320



0928-0112

## 10-GAUGE PUSHROD TUBE KITS

- Machined from 6061-T6 billet aluminum
- Lower tubes allow easy access for adjustable pushrods
- Each kit consists of lower tubes, spring cups, top clips and all necessary seals
- Require use of the OEM upper tubes, springs and washers
- Sold in a set of four

### PART #

### DESCRIPTION

#### FOR 17-20 M-EIGHT ENGINES

0925-1320

Black anodized

0925-1321

Titanium anodized

#### FOR 99-17 TWIN CAM ENGINES

0928-0111

Black anodized

0928-0112

Titanium anodized



0640-1451



0640-1450

## CAGED SERIES SIDEKICK MIRRORS

- Lightweight multi-piece design
- Forged from aluminum then CNC-machined to perfection
- Forged mirror stem
- Stainless steel machined pivot hardware
- Matches many popular lines of Ness accessories
- Oval mirror heads measure 13,8 W cm x 64 mm H (5,45" x 2,5")
- Sold each

### PART #

### DESCRIPTION

#### CHROME

0640-1451

Left

0640-1453

Right

#### BLACK ANODIZED

0640-1450

Left

0640-1452

Right

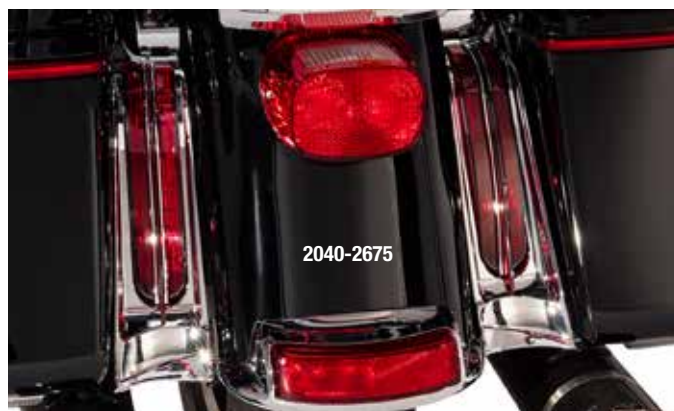

## FILLER PANEL LIGHTS

- Dramatically increase rear visibility
- Smooth out the back of your bike to create a finished custom look
- Unique Ciro multi-function controller provides red running and brake lighting with red turn signals
- Plasma LED turn-signal technology creates an effect that stands out even at great distance
- Easy plug-and-play installation
- Sold in pairs



PART #	DESCRIPTION
FOR 14-20 FLHT/FLHTCU/FLHTCUL/FLHTK/FLHTKL/FLHR/FLHRXS	
2040-2675	Chrome
2040-2676	Black
FOR 15-20 FLTRX/FLTRXS/FLTRU/FLTRK	
2040-2681	Chrome
2040-2682	Black



## FOOTREST ADAPTERS

- Mount any Ciro driver footrest to H-D male mounts
- Stainless steel construction
- Easy installation



PART #	DESCRIPTION
1620-2189	Footrest adapters



## BAG BLADES®

- One of the cleanest ways to add light to the back of your bike
- Low-profile light housings sit right below the saddlebag lids to blend seamlessly into the back of the bike
- Feature super-bright LED run, brake and sequential All Red turn signal styles to ensure you're seen, day or night
- Plug-and-play installation with no drilling
- Sold in pairs

PART #	DESCRIPTION
2040-2683	For 14-20 FLHT/FLHTCU/FLHTCUL/FLHTK/FLHTKL/FLHR/FLHRXS, 15-20 FLTRX/FLTRXS/FLTRU/FLTRK



## PROBEAM® REAR LED TURN SIGNALS

- Outer ring of 16 red LEDs that function as running lights
- 12 center red LEDs function as turn signal
- Available in chrome or black finish, smoke or red lens
- Plug-and-play
- Smart Triple Play® (PART #2050-0408) required for run/brake/turn signal function (sold separately)
- Sold in pairs

PART #	DESCRIPTION
FOR 15-20 INDIAN SCOUT/SCOUT SIXTY MODELS	
2020-1912	Black finish, smoke lens
2020-1913	Chrome finish, smoke lens
2020-1914	Black finish, red lens
2020-1915	Black finish, red lens



2040-2605



## RUN/BRAKE BACKREST LED LIGHTS

- Contain 100 chip-on-board LEDs
- Available with black or chrome finish
- For use with H-D sissy bars and passenger backrests
- Plug-and-play



2040-2608

PART #	DESCRIPTION
--------	-------------

FOR 14-20 FLHX/FLHXS/FLHXSE/FLTRX/FLTRXSE/FLTRXS/FLTRK/FLTRU/FLTRUSE/FLHT/FLHTCU/FLHTCUL/FLHTK/FLHTKL/FLHTKSE/FLHR/FLTRXSE/FLHRS MODELS	
---	--

2040-2605	Black
-----------	-------

2040-2606	Chrome
-----------	--------

FOR 10-13 FLHX/FLTRX MODELS	
-----------------------------	--

2040-2611	Black
-----------	-------

2040-2612	Chrome
-----------	--------

FOR 15-20 FLRT MODELS	
-----------------------	--

2040-2615	Black
-----------	-------

2040-2616	Chrome
-----------	--------

FOR 00-17 SOFTTAILS, 99-17 DYNA, 99-03 XL, AND 99-13 FLHR/FLHRC/FLTRU/FLTRUSE 99-09 FLTR, AND 06-09 FLHX MODELS	
---	--

2040-2607	Black
-----------	-------

2040-2608	Chrome
-----------	--------

FOR 04-13 XL MODELS (EXCEPT XL1200N, XL1200X, XL1200V, XR1200, XR1200X, AND XL883N MODELS)	
--	--

2040-2609	Black
-----------	-------

2040-2610	Chrome
-----------	--------

FOR 14-20 XL883N/XL1200NS/XL1200X/XL1200XS/XL1200V/XL1200CS MODELS	
--	--

2040-2613	Black
-----------	-------

2040-2614	Chrome
-----------	--------

FOR UNIVERSAL APPLICATIONS W/ 12VDC NEGATIVE GROUND SYSTEMS	
---	--

2040-2617	Black
-----------	-------

2040-2618	Chrome
-----------	--------



## REPLACEMENT TOMBSTONE TAILLIGHT LENS

- Smoke replacement lens for stock Tombstone taillight housing (OEM PART # 68280-05)
- Sold each

PART #	FITS MODEL
2010-1408	For 97-03 FLSTS, 05-07 FLSTSC, 05-17 FLSTN, 07-08 FLHRSE/FXSTSSE models

## PROBEAM® LOW-PROFILE LED TAILLIGHTS WITH INTEGRATED TURN SIGNALS

- Five LED running light pipes with full-contrast red brake LEDs
- Built-in left and right amber auxiliary turn signals
- Low-profile design protrudes 51 mm (2") from stock taillight baseplate
- Available with red or smoke lens
- Plug-and-play



2010-1412

PART #	DESCRIPTION
--------	-------------

FOR 99-20 FLHR, 19-20 FLHT, 18-20 FLHC, 99-13 FLHT/FLHTCU/FLHRC/FLTRU/FLTRUSE, 99-09 FLTR, 06-09 FLHX 99-17 SOFTTAILS (EXCEPT FXS/FLS/FXSB/FXSBSE/FLSTN/FLSTNSE/FXCWC, AND 10 FLSTSE2), 99-17 DYNA MODELS (EXCEPT 09-17 FXDB, 10-17 FXDWG) 14-19 XL883L/XL1200T, 99-13 XL MODELS (EXCEPT XL1200N, XL1200X, XL1200V OR XL883N)	
---	--

2010-1412	Bottom window, red lens
-----------	-------------------------

2010-1413	Bottom window, smoke lens
-----------	---------------------------

2010-1414	No window, red lens
-----------	---------------------

2010-1415	No window, smoke lens
-----------	-----------------------

2010-1416	Top window, red lens
-----------	----------------------

2010-1417	Top window, smoke lens
-----------	------------------------

## TOMBSTONE TAILLIGHT LED BOARD

- 48 dual-intensity red LED board with 1157 connector
- Direct replacement for stock bulb
- Provides super bright running and brake lights
- Plug-and-play

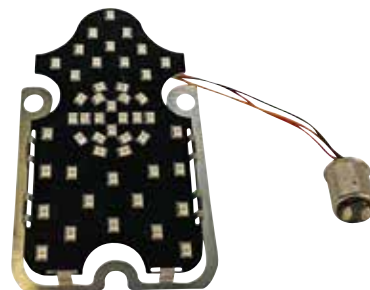

PART #	FITS MODEL
2010-1407	For 97-03 FLSTS, 05-07 FLSTSC, 05-17 FLSTN, 07-08 FLHRSE/FXSTSSE models



3501-1641



3501-1642



## RUBBER GROMMETS FOR SADDLEBAGS

- Push into place to protect wire, cable, and cords
- For 14 mm (9/16") hole diameter
- 3 mm (1/8") inner diameter, 19 mm (3/4") flange diameter
- Sold in pairs

PART #	DESCRIPTION
3501-1641	For 93-13 OEM hard saddlebags w/ 1/8" thickness
3501-1642	For 14-20 OEM hard saddlebags w/ 1/4" thickness

## BATTERY CABLES

- Black 4-gauge cable kit manufactured with pure electrolytic-grade, 36-gauge tinned copper strands for maximum current transfer and superior flexibility
- All cables feature 6,4 mm ( $\frac{1}{4}$ " ) and 7,9 mm ( $\frac{5}{16}$ " ) terminals
- Increases starter performance by supplying maximum battery current to the starter motor
- Contains all battery cables to replace OEM cables



PART #	DESCRIPTION
--------	-------------

2113-0736	For 09-13 FLHT/FLHR/FLHX/FLTR; cable lengths 16 cm ( $6\frac{1}{4}$ " ) w/ 32,5 cm ( $12\frac{3}{4}$ " ) auxiliary wire and 47,5 cm ( $18\frac{5}{8}$ " ) w/ 23,5 cm ( $9\frac{1}{4}$ " ); repl. OEM #s 70267-09, 90377-09
-----------	--



## RUBBER DRIVER FOOTPEGS

- Feature molded rubber sleeves with chrome-forged mounts
- Mount with existing stock hardware
- Sold in pairs

**NOTE:** See page 1670 of the Parts Europe FatBook for an explanation of footpeg mount styles.

PART #	DESCRIPTION
1620-1890	For 18-20 Softail/ELW Models



0407-0674

## FORK SEAL AND DUST WIPER KITS

- Seal profile is engineered to create equal pressure in each seal lip; equalized seal pressure creates less drag and longer seal life
- Patented MAX-LIFE has a coefficient of friction up to three times less than the OEM seal material
- Triple-lip seal design
- Directional ribs allow seal to be installed easily
- Kits include fork seals and dust wipers

PART #	DESCRIPTION
0407-0675	For 13-16 FXSB/SE, 08-11 FXCW/C, 06-17 FXD/FXDWG, 16-20 XL1200X/XS, 02-11 V-Rod (49 mm)
0407-0677	For 84-13 FXS/FXST, 93-05 FXDWG, 84-86 FXWG (41 mm)
0407-0674	For 91-05 FXD, L87-00 FXR, L87-20 XL (except XL1200X/XS (39 mm))
0407-0673	For 83-85 FXEF/SB, 84-E87 FXR, 83-E87 XL (35 mm)
0407-0676	For 15-20 XG500/750 (except 750A)



1620-1891



## SOFT-RIDE FOOTPEGS

- Designed to absorb vibrations
- Hollow core, long-lasting neoprene rubber insert cleats are isolastically mounted on a special chrome socket-head bolt

**NOTE:** See page 1583 of the Parts Europe FatBook for an explanation of footpeg mount styles.



1620-1892



PART #	DESCRIPTION
M-EIGHT SOFTAIL/ELW DRIVER FOOTPEGS	
1620-1891	Large diameter, chrome (pr.)
1620-1892	Large diameter, black (pr.)

## EASY FIND KICKSTAND EXTENSION

- Make hard-to-reach kickstands easier to operate
- Includes mounting hardware
- Available in gloss black

**NOTE:** Drilling required.



PART #	DESCRIPTION
0510-0506	For 91-17 FXD

0406-0097



## FORK BOOTS

- High quality black rubber construction
- Include zip ties for easy installation
- Removal of existing fork covers required for installation
- Sold in pairs

0406-0098



PART #	DESCRIPTION
FOR 41 MM FORKS	
0406-0097	9"
FOR 49 MM FORKS	
0406-0098	7"
0406-0099	9"

## NAMZ

A leader in motorcycle electronics and lighting, NAMZ has a goal of providing the very best electrical products and technical service in the industry. Their wiring harness adapters make for clean, quick plug-and-play installation of electronics with no cutting and splicing of the wire harness. For the latest motorcycle electrical tech to old-school or custom electrical needs, NAMZ has the parts and technical know-how to ensure everything stays connected.



### REAR WIRING HARNESSES AND ADAPTERS

- Plug-n-play installation
- Wiring matches OEM color-coding
- Connects to rear taillight circuit board
- Adapters allow Plug-n-Play connection for OEM harness to models listed
- Harness and adapters sold separately

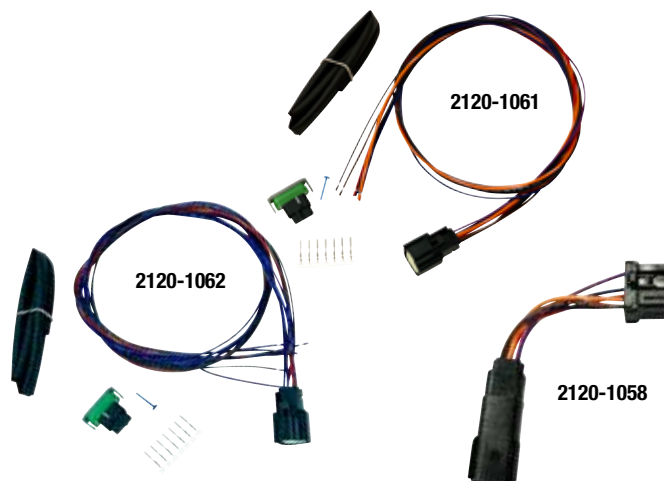

PART #	DESCRIPTION
<b>WIRING HARNESSES</b>	
<b>2120-1060</b>	For 97-13 FLHR/FLHTK/FLHX, 96-10 FLST, 97-11 FXD/FXDWG, 99-03 XL
<b>2120-1061</b>	For 10-13 FLTR/FLHX
<b>2120-1062</b>	For 14-20 FLHR/FLTR/FLHX/FLHT

PART #	DESCRIPTION
<b>WIRING HARNESS ADAPTERS</b>	
<b>2120-1058</b>	For 97-13 FLHR/FLHT, 98-09 FLTR, 06-09 FLHX using a 14-20 style harness
<b>2120-1059</b>	For 97-13 FLHR/FLHT, 98-09 FLTR, 06-09 FLHX using a 10-13 style harness



### TRANSMISSION NEUTRAL SWITCHES

- Zinc-plated OEM replacement switches



2106-0544



2106-0545

PART #	DESCRIPTION
<b>2106-0544</b>	For 03-20 XL, 06-08 Buell; repl. OEM #33900-99

PART #	DESCRIPTION
<b>2106-0545</b>	For 07-17 Dyna, 07-20 Softail/Touring models; repl. OEM #33926-06B



### M8 OIL PUMP ALIGNMENT TOOL

- Designed to aid in assembly of a complete cam chest correctly, in a quick and efficient manner
- Can be used by a technician to assemble as individual components with supplied studs or as an assembly with the alignment dowel, saving time and money



PART #	DESCRIPTION
<b>3801-0398</b>	For all M8 engines



### HEADLAMP COWL SCREW SET

- Duplicate of screws 2661W and 2662W
- Set of seven

PART #	DESCRIPTION
<b>2404-1026</b>	For 60-84 FL models, 60-73 Servi-Car



### REAR FENDER SUPPORT MOUNTING SCREWS AND NUTS

2401-1325

- Reproduction of 05 Phillips screws and locknuts
- Zinc- or chrome-plated
- $\frac{3}{8}$ "-24 X  $\frac{15}{16}$ "
- Sold in 2-pks

PART #	DESCRIPTION
FOR 84-00 FXST/FLST	
<b>2401-1325</b>	Zinc-plated
<b>2401-1326</b>	Chrome-plated



### REAR ROTOR TO HUB SCREW & NUT KIT

- Zinc-plated button head torx bolts

PART #	DESCRIPTION
<b>2401-1323</b>	For 92-20 XL/FLT/FXST/FLST/ FXD/ FXDWG; repl. OEM# 43567-92



2401-1320

### FRONT BRAKE ROTOR TO HUB TORX SCREW KITS

- Zinc-plated Torx head design
- $\frac{5}{16}$ "-18 X  $\frac{7}{8}$ "

PART #	DESCRIPTION
<b>2401-1320</b>	For 84-20 FX/FXR/XL/FLT front single disc; repl. OEM #3655A
<b>2401-1321</b>	For 84-10 FXST/FXWG; repl. OEM #3655A, 7739



### REAR DISK BRAKE ROTOR SCREW KIT

- Zinc-plated button head torx bolts
- $\frac{3}{8}$ "-16 X 1"

PART #	DESCRIPTION
<b>2401-1322</b>	For 97-21 HD models w/ cast rear wheels



### LINE FITTING

- Cadmium-plated brass
- $\frac{1}{8}$  NPT for use with  $\frac{5}{16}$ " hose

PART #	DESCRIPTION
<b>2404-1027</b>	For 52-20 Big Twin and Sportster models; repl. OEM# 63578-52